

## **Ford 1979-1998**

### **Model 70 /267 Rear Axles for**

**Ambulance**

**Continental Bakery Chassis**

**E-250, E-350, E-450**

**F-350**

**UPS Chassis**

# Ford Model 70 /267 Rear Axles Exploded View

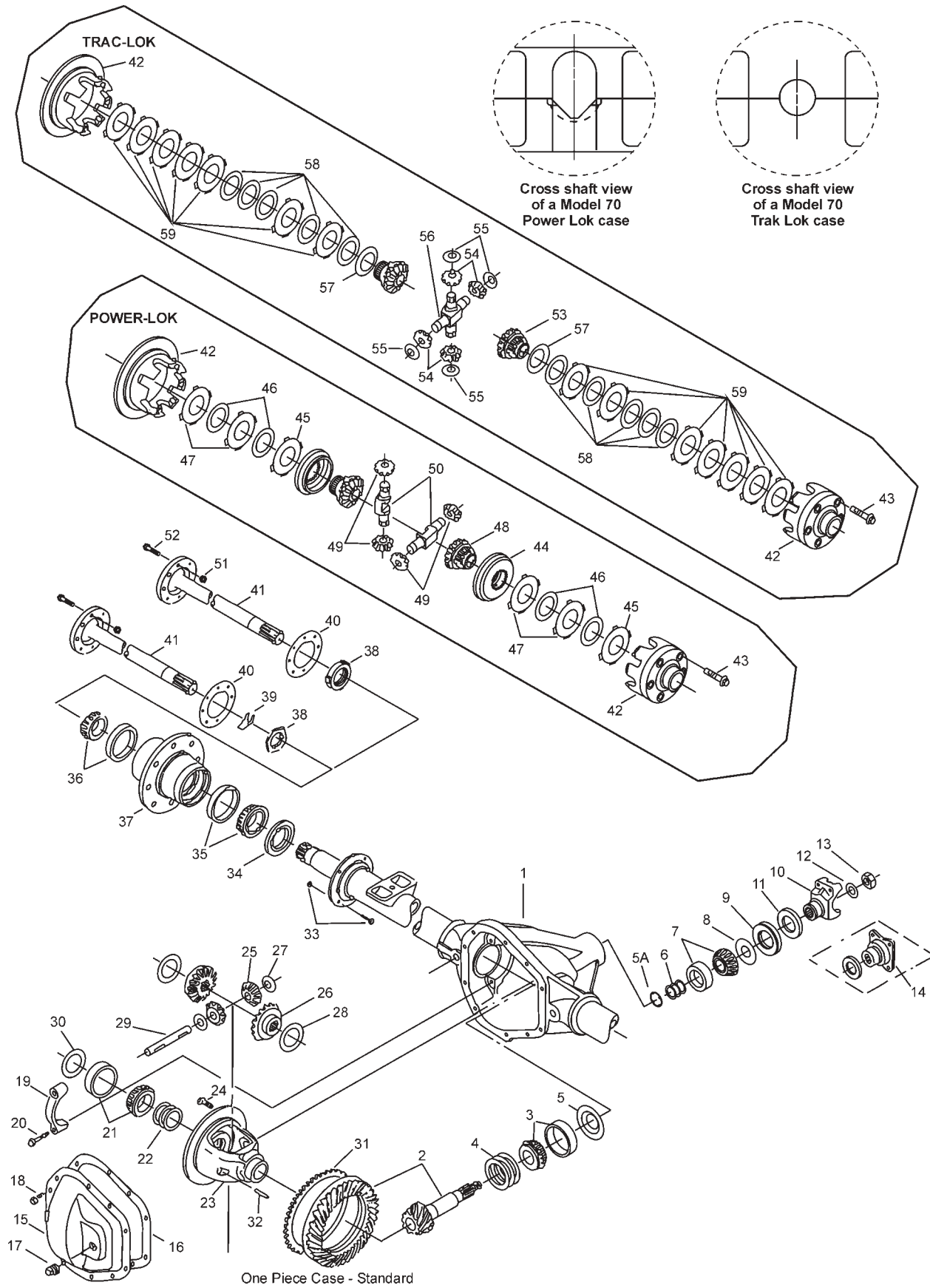

# Ford Model 70 /267 Rear Axles

## Parts Listing

ITEM NO.	PART NUMBER	DESCRIPTION	ITEM NO.	PART NUMBER	DESCRIPTION
1	— <sup>(3)</sup>	Housing – Axle Service	24	— <sup>(2)</sup>	Bolt – Drive Gear (qty 12)
2	— <sup>(1)</sup>	Drive Pinion & Gear Assembly	25	35080	Pinion – Differential (std)
3	— <sup>(2)</sup>	KIT – Inner Pinion Bearing	26	— <sup>(2)</sup>	Gear – Differential (std)
4	—	Inner Pinion Shims (see shim packages)	27	35082	Thrustwasher – Diff Pinion (std)
	— <sup>(2)</sup>	PKG – Pinion Bearing Shim (inc items 4, 6, 12, 13, 15, 16)	28	34729	Thrustwasher – Diff Gear (std)
5	— <sup>(2)</sup>	Baffle – Pinion Bearing	29	46640	Shaft – Differential (std)
5A	46176	Spacer – Flat	30	— <sup>(2)</sup>	Spacer – Differential Bearing
6	— <sup>(4)</sup>	Outer Pinion Shims (see shim packages)	31	— <sup>(2)</sup>	Tone Ring
	— <sup>(2)</sup>	PKG – Diff & Pinion Bearing Shim (inc items 4, 6, 12, 13, 16, 22)	32	47024	Lock – Differential Shaft
7	706045X	KIT – Outer Pinion Bearing	33	— <sup>(3)</sup>	Nut/Bolt – Brake Mounting
8	42737	Thrustwasher – Bearing	34	— <sup>(2)</sup>	Seal – Hub
9	42449	Seal – Pinion Oil	35	— <sup>(2)</sup>	KIT – Inner Wheel Bearing
10	— <sup>(2)</sup>	End Yoke Assembly (inc 11)	36	— <sup>(2)</sup>	KIT – Outer Wheel Bearing
11	— <sup>(2)</sup>	Slinger – End Yoke	37	— <sup>(3)</sup>	Wheel Hub
12	30275	Washer – Pinion Nut	38	— <sup>(2)</sup>	Spindle Nut / Wheel Bearing Retainer
13	30271	Pinion Nut	39	— <sup>(2)</sup>	Wheel Bearing Retainer (Left Hand)
14	— <sup>(2)</sup>	Companion Flange Assembly	40	39697	Locking Wedge
	— <sup>(2)</sup>	KIT – Carrier Cover (inc items 14, 15, 16, 17)	41	— <sup>(1)</sup>	Gasket
15	— <sup>(2)</sup>	Carrier Cover	42	— <sup>(4)</sup>	Shaft – Axle Flange Drive
16	—	Gasket – Carrier Cover	43	41610-1	Case – Differential
17	— <sup>(2)</sup>	Plug – Carrier Cover	44	42522	Bolt – Differential Case
18	— <sup>(2)</sup>	Bolt – Carrier Cover (qty 10)	45	707075X	Ring – Differential Gear (p/l)
19	— <sup>(3)</sup>	Differential Bearing Cap			KIT – Differential Plate & Disc (p/l) (inc items 45, 46, 47)
20	48632-1	Bolt – Differential Bearing Cap	46	— <sup>(4)</sup>	Plate – Differential
21	— <sup>(2)</sup>	KIT – Differential Bearing	47	— <sup>(4)</sup>	Disc – Differential
22	— <sup>(2)</sup>	PKG – Diff Bearing Shim (inc 16)	48	— <sup>(2)</sup>	Plate – Differential
23	— <sup>(4)</sup>	Case – Differential (std)	49	31040	Gear – Differential (p/l)
			50	31041	Pinion – Differential (p/l)
			51	— <sup>(2)</sup>	Shaft – Differential (p/l)
			52	— <sup>(2)</sup>	Lockwasher
					Screw – Flange Head

(1) See "Bill of Material Table" on next page

(2) See "Variable Parts Table" within this section

(3) Contact Vehicle Manufacturer

(4) Not Sold Separately

(5) See Camber/Casting Bushing Table at the back of the Ford section of this catalog

# Ford Model 70 /267 Rear Axles

## Bill of Material Table

Axle			Axle Kits				Shaft & Joint Assy.	
Bill of Material	Diff. Type	Ratio	Ring Gear & Pinion Kit <sup>(7)</sup>	Differential			Right Hand Shaft Assy.	Left Hand Shaft Assy.
				Case Assy. Kit <sup>(8)</sup>	Case Kit	Inner Parts Kit		
<b>1979 E-350 - 70B</b>								
603938-1	Standard	3.73	706999-3X	706051X	706055X	706058X	36113-8	36113-6
603938-2	Standard	3.73	706999-3X	706051X	706055X	706058X	36113-8	36113-6
603938-3	Standard	4.10	706999-4X	706051X	706055X	706058X	36113-8	36113-6
603938-4	Powr Lok	4.10	706999-4X	706049X	706053X	707074X	36113-8	36113-6
603938-5	Standard	4.56	706999-6X	706052X	706056X	706058X	36113-8	36113-6
603938-6	Standard	4.10	706999-4X	706051X	706055X	706058X	36113-8	36113-6
603938-7	Powr Lok	4.10	706999-4X	706049X	706053X	707074X	36113-8	36113-6
603938-8	Standard	4.56	706999-6X	706052X	706056X	706058X	36113-8	36113-6
<b>1979 F-350 - 70B</b>								
603937-1	Standard	3.73	706999-2X	706051X	706055X	706058X	36113-1	36113-1
603937-2	Standard	3.73	706999-2X	706051X	706055X	706058X	36113-1	36113-1
603937-3	Powr Lok	4.10	706999-4X	706049X	706053X	707074X	36113-1	36113-1
603937-4	Standard	4.56	706999-6X	706052X	706056X	706058X	36113-1	36113-1
603937-5	Standard	4.10	706999-4X	706051X	706055X	706058X	36113-1	36113-1
603937-6	Standard	4.56	706999-6X	706052X	706056X	706058X	36113-1	36113-1
603937-7	Standard	5.13	706999-9X	706052X	706056X	706058X	36113-1	36113-1
603937-8	No Spin	4.10	706999-4X	28286X	706083X	35683	36113-1	36113-1
603937-9	No Spin	4.56	706999-6X	28284X	706084X	35683	36113-1	36113-1
603937-10	Standard	7.17	706999-14X	706052X	706056X	706058X	36113-1	36113-1
603937-11	No Spin	3.73	706999-2X	28286X	706083X	35683	36113-1	36113-1
603937-12	Standard	4.56	706999-6X	706052X	706056X	706058X	36113-1	36113-1
603937-13	Powr Lok	4.56	706999-6X	706050X	706054X	707074X	36113-1	36113-1
603937-14	No Spin	4.56	706999-6X	28284X	706084X	35683	36113-1	36113-1
603935-1	Standard	3.73	706999-2X	706051X	706055X	706058X	36113-1	36113-1
603935-2	Powr Lok	4.10	706999-4X	706049X	706053X	707074X	36113-1	36113-1
603935-3	Powr Lok	3.73	706999-2X	706049X	706053X	707074X	36113-1	36113-1
<b>1979-80 E-350 - 70HD</b>								
603940-1	Standard	4.10	706999-4X	706064X	706068X	706058X	36113-8	36113-6
603940-2	Powr Lok	4.10	706999-4X	707028X <sup>(9)</sup>	707029X	707074X	36113-8	36113-6
603940-3	Standard	4.10	706999-4X	706064X	706068X	706058X	36113-8	36113-6
603940-4	Powr Lok	4.10	706999-4X	707028X <sup>(9)</sup>	707029X	707074X	36113-8	36113-6
<b>1979-80 E-350 Van - 70B</b>								
603934-1	Standard	3.73	706999-3X	706051X	706055X	706058X	36113-7	36113-8
603934-2	Standard	3.73	706999-3X	706051X	706055X	706058X	36113-7	36113-8
603934-3	Standard	4.10	706999-4X	706051X	706055X	706058X	36113-7	36113-8
603934-4	Powr Lok	4.10	706999-4X	706049X	706053X	707074X	36113-7	36113-8
603934-5	Powr Lok	3.73	706999-3X	706049X	706053X	707074X	36113-7	36113-8
603934-6	Standard	4.56	706999-6X	706052X	706052X	706058X	36113-7	36113-8
603934-7	Standard	4.10	706999-4X	706051X	706055X	706058X	36113-7	36113-8
603934-8	Powr Lok	4.10	706999-4X	706049X	706053X	707074X	36113-7	36113-8
603934-9	Standard	7.17	706999-14X	706052X	706056X	706058X	36113-7	36113-8
603934-10	Standard	4.56	706999-6X	706052X	706056X	706058X	36113-7	36113-8
<b>1979-80 F-350 U-Haul - 70B</b>								
603936-1	Standard	4.10	706999-4X	706051X	706055X	706058X	36113-1	36113-1
603936-2	Standard	4.56	706999-6X	706052X	706056X	706058X	36113-1	36113-1
603936-3	Standard	4.10	706999-4X	706051X	706055X	706058X	36113-1	36113-1

(7) See Ring Gear & Pinion Kits in XGI Catalog for ratio & tooth combinations.  
(8) See Differential Case Assy Kits in XGI Catalog for spline data & ratios.  
(9) May require 34848-10 & 34848-28 differential bearing spacers.

# Ford Model 70 /267 Rear Axles

## Bill of Material Table

Axle			Axle Kits				Shaft & Joint Assy.	
Bill of Material	Diff. Type	Ratio	Ring Gear & Pinion Kit <sup>(7)</sup>	Differential			Right Hand Shaft Assy.	Left Hand Shaft Assy.
				Case Assy. Kit <sup>(8)</sup>	Case Kit	Inner Parts Kit		
<b>1980 Ambulance - 70HD</b>								
603909-1	Standard	3.73	706999-2X	706064X	706068X	706058X	36113-17	36113-17
603909-2	Powr Lok	3.73	706999-2X	707028X <sup>(9)</sup>	707029X	707074X	36113-17	36113-17
603909-3	Powr Lok	4.10	706999-4X	707028X <sup>(9)</sup>	707029X	707074X	36113-17	36113-17
603909-4	Powr Lok	3.73	706999-2X	707028X <sup>(9)</sup>	707029X	707074X	36113-17	36113-17
603909-5	Powr Lok	4.10	706999-4X	707028X <sup>(9)</sup>	707029X	707074X	36113-17	36113-17
<b>1980 F-350 - 70B</b>								
603962-1	Standard	3.73	706999-2X	706051X	706055X	706058X	36113-1	36113-1
603962-2	Standard	3.73	706999-2X	706051X	706055X	706058X	36113-1	36113-1
603962-3	Standard	4.10	706999-4X	706051X	706055X	706058X	36113-1	36113-1
603962-4	Powr Lok	4.10	706999-4X	706049X	706053X	707074X	36113-1	36113-1
603962-5	Standard	4.10	706999-4X	706051X	706055X	706058X	36113-1	36113-1
603962-6	Powr Lok	4.10	706999-4X	706049X	706053X	707074X	36113-1	36113-1
603962-7	Standard	4.56	706999-6X	706052X	706056X	706058X	36113-1	36113-1
603962-8	No Spin	4.10	706999-4X	28286X	706083X	35683	36113-1	36113-1
603962-9	Powr Lok	4.56	706999-6X	706050X	706054X	707074X	36113-1	36113-1
603962-10	Standard	7.17	706999-14X	706052X	706056X	706058X	36113-1	36113-1
<b>1980 F-350 Big Dooley - 70HD</b>								
603949-1	Standard	3.73	706999-4X	706064X	706068X	706058X	36113-18	36113-19
603949-2	Powr Lok	4.10	706999-4X	707028X <sup>(9)</sup>	707029X	707074X	36113-18	36113-19
603949-5	Standard	4.56	706999-6X	706065X	706069X	706058X	36113-18	36113-19
603949-6	Standard	3.73	706999-2X	706064X	706068X	706058X	36113-18	36113-19
<b>1981-82 E-350 - 70B</b>								
605042-1	Standard	3.73	706999-2X	706051X	706055X	706058X	36113-8	36113-6
605042-2	Standard	4.10	706999-4X	706051X	706055X	706058X	36113-8	36113-6
605042-3	Powr Lok	4.10	706999-4X	706049X	706053X	707074X	36113-8	36113-6
605042-4	Standard	4.56	706999-6X	706052X	706056X	706058X	36113-8	36113-6
605042-5	Powr Lok	3.73	706999-2X	706049X	706053X	707074X	36113-8	36113-6
605042-6	Standard	7.17	706999-14X	706052X	706056X	706058X	36113-8	36113-6
605042-7	Standard	3.73	706999-2X	706051X	706055X	706058X	36113-8	36113-6
605042-8	Standard	4.10	706999-4X	706051X	706055X	706058X	36113-8	36113-6
605042-9	Powr Lok	4.10	706999-4X	706049X	706053X	707074X	36113-8	36113-6
605042-10	Standard	4.56	706999-6X	706052X	706056X	706058X	36113-8	36113-6
605042-11	Powr Lok	3.73	706999-2X	706049X	706053X	707074X	36113-8	36113-6
605042-12	Standard	7.17	706999-14X	706052X	706056X	706058X	36113-8	36113-6
<b>1981-82 E-350 School Bus - 70B</b>								
605057-1	Standard	3.73	706999-2X	706051X	706055X	706058X	36113-8	36113-6
605057-2	Standard	4.10	706999-4X	706051X	706055X	706058X	36113-8	36113-6
605057-3	Powr Lok	4.10	706999-4X	706049X	706053X	707074X	36113-8	36113-6
605057-4	Powr Lok	3.73	706999-2X	706049X	706053X	707074X	36113-8	36113-6
605057-5	Standard	3.73	706999-2X	706051X	706055X	706058X	36113-8	36113-6
605057-6	Standard	4.10	706999-4X	706051X	706055X	706058X	36113-8	36113-6
605057-7	Powr Lok	4.10	706999-4X	706049X	706053X	707074X	36113-8	36113-6
605057-8	Powr Lok	3.73	706999-2X	706049X	706053X	707074X	36113-8	36113-6
<b>1981-82 F-350 DSO Ambulance - 70HD</b>								
605055-1	Standard	3.73	706999-2X	706064X	706068X	706058X	36113-17	36113-17
605055-3	Powr Lok	4.10	706999-4X	707028X <sup>(9)</sup>	707029X	707074X	36113-17	36113-17
605055-5	Powr Lok	4.10	706999-4X	707028X <sup>(9)</sup>	707029X	707074X	36113-17	36113-17
605055-6	Standard	7.17	706999-14X	706065X	706069X	706058X	36113-17	36113-17

(7) See Ring Gear &amp; Pinion Kits in XGI Catalog for ratio &amp; tooth combinations.

(8) See Differential Case Assy Kits in XGI Catalog for spline data &amp; ratios.

(9) May require 34848-10 &amp; 34848-28 differential bearing spacers.

# Ford Model 70 /267 Rear Axles

## Bill of Material Table

Axle			Axle Kits				Shaft & Joint Assy.	
Bill of Material	Diff. Type	Ratio	Ring Gear & Pinion Kit <sup>(7)</sup>	Differential			Right Hand Shaft Assy.	Left Hand Shaft Assy.
				Case Assy. Kit <sup>(8)</sup>	Case Kit	Inner Parts Kit		
<b>1981-83 F-350 DSO Dual Wheel - 70B</b>								
605038-1	Standard	3.73	706999-2X	706051X	706055X	706058X	36113-1	36113-1
605038-2	Standard	4.10	706999-4X	706051X	706055X	706058X	36113-1	36113-1
605038-3	Powr Lok	4.10	706999-4X	706049X	706053X	707074X	36113-1	36113-1
605038-4	Standard	4.56	706999-6X	706052X	706056X	706058X	36113-1	36113-1
605038-5	Standard	7.17	706999-14X	706052X	706056X	706058X	36113-1	36113-1
605038-6	Powr Lok	4.10	706999-4X	706049X	706053X	707074X	36113-1	36113-1
605038-7	Powr Lok	4.56	706999-6X	706050X	706054X	707074X	36113-1	36113-1
605038-8	Powr Lok	7.17	706999-14X	706050X	706054X	707074X	36113-1	36113-1
605038-10	Powr Lok	3.54	706999-1X	706049X	706053X	707074X	36113-1	36113-1
605038-11	No Spin	7.17	706999-14X	28284X	706084X	35683	36113-1	36113-1
605038-12	Standard	3.73	706999-2X	706051X	706055X	706058X	36113-1	36113-1
605038-13	Standard	4.10	706999-4X	706051X	706055X	706058X	36113-1	36113-1
605038-14	Powr Lok	4.10	706999-4X	706049X	706053X	707074X	36113-1	36113-1
605038-15	Powr Lok	4.10	706999-4X	706049X	706053X	707074X	36113-1	36113-1
605038-16	Standard	7.17	706999-14X	706052X	706056X	706058X	36113-1	36113-1
605038-17	No Spin	4.10	706999-4X	706049X	706053X	707074X	36113-1	36113-1
605038-18	Powr Lok	4.56	706999-6X	706050X	706054X	707074X	36113-1	36113-1
605038-19	Powr Lok	7.17	706999-14X	706050X	706054X	707074X	36113-1	36113-1
605038-20	Standard	3.54	706999-1X	706051X	706055X	706058X	36113-1	36113-1
605038-22	No Spin	7.17	706999-14X	28284X	706084X	35683	36113-1	36113-1
<b>1981-83 F-350 Heavy Duty Chassis - 70HD</b>								
605044-1	Standard	4.10	706999-4X	706064X	706068X	706058X	36113-1	36113-1
605044-2	Powr Lok	4.10	706999-4X	707028X <sup>(9)</sup>	707029X	707074X	36113-1	36113-1
605044-3	Standard	3.73	706999-2X	706064X	706068X	706058X	36113-1	36113-1
605044-4	Standard	4.56	706999-6X	706065X	706069X	706058X	36113-1	36113-1
605044-5	Powr Lok	4.56	706999-6X	706063X	706730X	707074X	36113-1	36113-1
605044-6	Standard	7.17	706999-14X	706065X	706069X	706058X	36113-1	36113-1
605044-7	No Spin	7.17	706999-14X	26996X	706098X	35683	36113-1	36113-1
605044-8	No Spin	4.10	706999-4X	70716X	706185X	35683	36113-1	36113-1
605044-9	Standard	6.17	706999-12X	706065X	706069X	706058X	36113-1	36113-1
605044-10	Standard	4.10	706999-4X	706064X	706068X	706058X	36113-1	36113-1
605044-11	Powr Lok	4.10	706999-4X	707028X <sup>(9)</sup>	707029X	707074X	36113-1	36113-1
605044-12	Standard	3.73	706999-2X	706064X	706068X	706058X	36113-1	36113-1
605044-13	Standard	4.56	706999-6X	706065X	706069X	706058X	36113-1	36113-1
605044-14	Powr Lok	4.56	706999-6X	706063X	706730X	707074X	36113-1	36113-1
605044-15	Standard	7.17	706999-14X	706065X	706069X	706058X	36113-1	36113-1
605044-16	No Spin	7.17	706999-14X	26996X	706098X	35683	36113-1	36113-1
605044-17	No Spin	4.10	706999-4X	70716X	706185X	35683	36113-1	36113-1
605044-18	Standard	6.17	706999-12X	706065X	706069X	706058X	36113-1	36113-1
<b>1981-83 F-350 Dual Wheel - 70HD</b>								
605045-1	Standard	4.10	706999-4X	706064X	706068X	706058X	36113-18	36113-19
605045-2	Powr Lok	4.10	706999-4X	707028X <sup>(9)</sup>	707029X	707074X	36113-18	36113-19
605045-3	Standard	4.56	706999-6X	706065X	706069X	706058X	36113-18	36113-19
605045-4	Standard	3.73	706999-2X	706064X	706068X	706058X	36113-18	36113-19
605045-5	Standard	4.10	706999-4X	706064X	706068X	706058X	36113-18	36113-19
605045-6	Powr Lok	4.10	706999-4X	707028X <sup>(9)</sup>	707029X	707074X	36113-18	36113-19
605045-7	Standard	4.56	706999-6X	706065X	706069X	706058X	36113-18	36113-19

**Continued on next page**

(7) See Ring Gear & Pinion Kits in XGI Catalog for ratio & tooth combinations.  
 (8) See Differential Case Assy Kits in XGI Catalog for spline data & ratios.  
 (9) May require 34848-10 & 34848-28 differential bearing spacers.



# Ford Model 70 /267 Rear Axles

## Bill of Material Table

Axle			Axle Kits				Shaft & Joint Assy.	
Bill of Material	Diff. Type	Ratio	Ring Gear & Pinion Kit <sup>(7)</sup>	Differential			Right Hand Shaft Assy.	Left Hand Shaft Assy.
				Case Assy. Kit <sup>(8)</sup>	Case Kit	Inner Parts Kit		
<b>1981-83 F-350 Dual Wheel - 70HD (Continued)</b>								
605045-8	Standard	3.73	706999-2X	706064X	706068X	706058X	36113-18	36113-19
605045-9	Standard	3.54	706999-1X	706064X	706068X	706058X	36113-18	36113-19
605045-10	Powr Lok	3.54	706999-1X	706064X	707029X	706058X	36113-18	36113-19
605045-11	Standard	4.56	706999-6X	706065X	706069X	706058X	36113-18	36113-19
605045-12	Standard	4.10	706999-4X	706064X	706068X	706058X	36113-18	36113-19
605045-13	Powr Lok	4.10	706999-4X	707028X <sup>(9)</sup>	707029X	707074X	36113-18	36113-19
605045-14	Standard	4.56	706999-6X	706065X	706069X	706058X	36113-18	36113-19
605045-15	Standard	3.73	706999-2X	706064X	706068X	706058X	36113-18	36113-19
605045-16	Standard	4.10	706999-4X	706064X	706068X	706058X	36113-18	36113-19
605045-17	Powr Lok	4.10	706999-4X	707028X <sup>(9)</sup>	707029X	707074X	36113-18	36113-19
605045-18	Standard	4.56	706999-6X	706065X	706069X	706058X	36113-18	36113-19
605045-19	Standard	3.73	706999-2X	706064X	706068X	706058X	36113-18	36113-19
605045-22	Standard	4.56	706999-6X	706065X	706069X	706058X	36113-18	36113-19
<b>1981-83 F-350 U-Haul - 70B</b>								
605054-1	Standard	4.10	706999-4X	706051X	706055X	706058X	36113-1	36113-1
605054-3	Standard	4.10	706999-4X	706051X	706055X	706058X	36113-1	36113-1
605054-4	Standard	4.10	706999-4X	706051X	706055X	706058X	36113-1	36113-1
605054-6	Standard	4.10	706999-4X	706051X	706055X	706058X	36113-1	36113-1
<b>1981-85 E-350 DSO - 70HD</b>								
605053-2	Powr Lok	4.10	706999-4X	707028X <sup>(9)</sup>	707029X	707074X	36113-8	36113-6
605053-3	Standard	4.10	706999-4X	706064X	706068X	706058X	36113-8	36113-6
605053-4	Powr Lok	4.10	706999-4X	707028X <sup>(9)</sup>	707029X	707074X	36113-8	36113-6
605053-5	Standard	3.73	706999-2X	706064X	706068X	706058X	36113-8	36113-6
605053-6	Powr Lok	3.73	706999-2X	707028X <sup>(9)</sup>	707029X	707074X	36113-8	36113-6
605053-7	Standard	4.10	706999-4X	706064X	706068X	706058X	36113-8	36113-6
605053-8	Powr Lok	4.10	706999-4X	707028X <sup>(9)</sup>	707029X	707074X	36113-8	36113-6
605053-9	Standard	4.10	706999-4X	706064X	706068X	706058X	36113-8	36113-6
605053-10	Powr Lok	4.10	706999-4X	707028X <sup>(9)</sup>	707029X	707074X	36113-8	36113-6
605053-11	Standard	3.73	706999-2X	706064X	706068X	706058X	36113-8	36113-6
605053-12	Powr Lok	3.73	706999-2X	707028X <sup>(9)</sup>	707029X	707074X	36113-8	36113-6
605053-13	Standard	4.10	706999-4X	706064X	706068X	706058X	36113-8	36113-6
605053-14	Powr Lok	4.10	706999-4X	707028X <sup>(9)</sup>	707029X	707074X	36113-8	36113-6
605053-15	Standard	3.73	706999-2X	706064X	706068X	706058X	36113-8	36113-6
605053-16	Powr Lok	3.73	706999-2X	707028X <sup>(9)</sup>	707029X	707074X	36113-8	36113-6
605053-17	Standard	3.54	706999-1X	706064X	706068X	706058X	36113-8	36113-6
605053-18	Powr Lok	3.54	706999-1X	707028X <sup>(9)</sup>	707029X	707074X	36113-8	36113-6
605053-19	Standard	4.10	706999-4X	706064X	706068X	706058X	36113-8	36113-6
605053-20	Powr Lok	4.10	706999-4X	707028X <sup>(9)</sup>	707029X	707074X	36113-8	36113-6
605053-22	Powr Lok	3.73	706999-2X	707028X <sup>(9)</sup>	707029X	707074X	36113-8	36113-6
<b>1981 1/2-83 E-350 DSO - 70B</b>								
605080-2	Standard	4.10	706999-4X	706051X	706055X	706058X	36113-8	36113-6
605080-4	Standard	4.56	706999-6X	706052X	706056X	706058X	36113-8	36113-6
<b>1981 1/2-83 E-350 DSO - 70HD</b>								
605101-1	Standard	4.10	706999-4X	706064X	706068X	706058X	36113-8	36113-6
605101-2	Powr Lok	4.10	706999-4X	707028X <sup>(9)</sup>	707029X	707074X	36113-8	36113-6
605101-3	Standard	4.10	706999-4X	706064X	706068X	706058X	36113-8	36113-6
605101-4	Powr Lok	4.10	706999-4X	707028X <sup>(9)</sup>	707029X	707074X	36113-8	36113-6

(7) See Ring Gear &amp; Pinion Kits in XGI Catalog for ratio &amp; tooth combinations.

(8) See Differential Case Assy Kits in XGI Catalog for spline data &amp; ratios.

(9) May require 34848-10 &amp; 34848-28 differential bearing spacers.

# Ford Model 70 /267 Rear Axles

## Bill of Material Table

Axle			Axle Kits				Shaft & Joint Assy.	
Bill of Material	Diff. Type	Ratio	Ring Gear & Pinion Kit <sup>(7)</sup>	Differential			Right Hand Shaft Assy.	Left Hand Shaft Assy.
				Case Assy. Kit <sup>(8)</sup>	Case Kit	Inner Parts Kit		
<b>1982 1/2-83 E-350 DSO - 70B</b>								
605139-1	Standard	3.73	706999-2X	706051X	706055X	706058X	36113-1	36113-1
<b>1982 1/2-83 E-350 DSO - 70U</b>								
605114-1	Standard	3.73	706998-2X	706051X	706055X	706058X	36113-8	36113-6
605114-2	Standard	4.10	706998-3X	706051X	706055X	706058X	36113-8	36113-6
605114-3	Powr Lok	4.10	706998-3X	706049X	706053X	707074X	36113-8	36113-6
605114-4	Standard	4.56	706998-4X	706052X	706056X	706058X	36113-8	36113-6
605114-5	Powr Lok	3.73	706998-2X	706049X	706053X	707074X	36113-8	36113-6
605114-6	Standard	3.54	706998-1X	706051X	706055X	706058X	36113-8	36113-6
605114-7	Standard	7.17	706998-9X	706052X	706056X	706058X	36113-8	36113-6
605114-8	Standard	3.73	706998-2X	706051X	706055X	706058X	36113-8	36113-6
605114-9	Standard	4.10	706998-3X	706051X	706055X	706058X	36113-8	36113-6
605114-10	Powr Lok	4.10	706998-3X	706049X	706053X	707074X	36113-8	36113-6
605114-11	Standard	4.56	706998-4X	706052X	706056X	706058X	36113-8	36113-6
605114-12	Powr Lok	3.73	706998-2X	706049X	706053X	707074X	36113-8	36113-6
605114-13	Standard	3.54	706998-1X	706051X	706055X	706058X	36113-8	36113-6
605114-14	Standard	7.17	706998-9X	706052X	706056X	706058X	36113-8	36113-6
605114-15	Standard	3.54	706998-1X	706051X	706055X	706058X	36113-8	36113-6
605114-16	Powr Lok	3.73	706998-2X	706049X	706053X	707074X	36113-8	36113-6
605114-17	Standard	4.10	706998-3X	706051X	706055X	706058X	36113-8	36113-6
605114-18	Powr Lok	4.10	706998-3X	706049X	706053X	707074X	36113-8	36113-6
605114-19	Standard	3.54	706998-1X	706051X	706055X	706058X	36113-8	36113-6
605114-26	Standard	7.17	706998-9X	706052X	706056X	706058X	36113-8	36113-6
<b>1982 1/2-83 F-350 DSO Wide Track - 70HD</b>								
605118-1	Standard	3.73	706999-2X	706064X	706068X	706058X	36113-17	36113-17
605118-2	Powr Lok	4.10	706999-4X	707028X <sup>(9)</sup>	707029X	707074X	36113-17	36113-17
605118-3	Standard	3.54	706999-1X	706064X	706068X	706058X	36113-17	36113-17
605118-4	Standard	4.10	706999-4X	706064X	706068X	706058X	36113-17	36113-17
605118-5	Standard	3.73	706999-2X	706064X	706068X	706058X	36113-17	36113-17
605118-6	Powr Lok	4.10	706999-4X	707028X <sup>(9)</sup>	707029X	707074X	36113-17	36113-17
605118-7	Standard	3.54	706999-1X	706064X	706068X	706058X	36113-17	36113-17
605118-8	Standard	4.10	706999-4X	706064X	706068X	706058X	36113-17	36113-17
<b>1982 1/2-83 1/2 F-350 DSO Ambulance - 70HD</b>								
605138-1	Powr Lok	4.10	706999-4X	707028X <sup>(9)</sup>	707029X	707074X	36113-17	36113-17
605138-2	Standard	3.73	706999-2X	706064X	706068X	706058X	36113-17	36113-17
605138-3	Powr Lok	3.73	706999-2X	707028X <sup>(9)</sup>	707029X	707074X	36113-17	36113-17
605138-4	Powr Lok	4.10	706999-4X	707028X <sup>(9)</sup>	707029X	707074X	36113-17	36113-17
605138-5	Standard	3.73	706999-2X	706064X	706068X	706058X	36113-17	36113-17
605138-6	Powr Lok	3.73	706999-2X	707028X <sup>(9)</sup>	707029X	707074X	36113-17	36113-17
<b>1983 E-350 DSO - 70U</b>								
605115-1	Standard	3.73	706998-2X	706051X	706055X	706058X	36113-8	36113-6
605115-2	Standard	4.10	706998-3X	706051X	706055X	706058X	36113-8	36113-6
605115-3	Powr Lok	4.10	706998-3X	706049X	706053X	707074X	36113-8	36113-6
605115-4	Powr Lok	3.73	706998-2X	706049X	706053X	707074X	36113-8	36113-6
605115-5	Standard	3.54	706998-1X	706051X	706055X	706058X	36113-8	36113-6
605115-6	Standard	3.73	706998-2X	706051X	706055X	706058X	36113-8	36113-6
605115-7	Standard	4.10	706998-3X	706051X	706055X	706058X	36113-8	36113-6
605115-8	Powr Lok	4.10	706998-3X	706049X	706053X	707074X	36113-8	36113-6
605115-9	Powr Lok	3.73	706998-2X	706049X	706053X	707074X	36113-8	36113-6
605115-10	Standard	3.54	706998-1X	706051X	706055X	706058X	36113-8	36113-6

(7) See Ring Gear & Pinion Kits in XGI Catalog for ratio & tooth combinations.

(8) See Differential Case Assy Kits in XGI Catalog for spline data & ratios.

(9) May require 34848-10 & 34848-28 differential bearing spacers.



# Ford Model 70 /267 Rear Axles

## Bill of Material Table

Axle			Axle Kits				Shaft & Joint Assy.	
Bill of Material	Diff. Type	Ratio	Ring Gear & Pinion Kit <sup>(7)</sup>	Differential			Right Hand Shaft Assy.	Left Hand Shaft Assy.
				Case Assy. Kit <sup>(8)</sup>	Case Kit	Inner Parts Kit		
<b>1983 1/2 E-350 DSO - 70B</b>								
605143-1	Standard	4.10	706999-4X	706051X	706055X	706058X	36113-8	36113-6
605143-2	Standard	4.56	706999-6X	706052X	706056X	706058X	36113-8	36113-6
<b>1983 1/2 F-350 - 70U</b>								
605175-1	Standard	3.54	706998-1X	706051X	706055X	706058X	36113-1	36113-1
605175-2	Powr Lok	3.54	706998-1X	706049X	706053X	707074X	36113-1	36113-1
605175-3	Standard	4.10	706998-3X	706051X	706055X	706058X	36113-1	36113-1
605175-4	Powr Lok	4.10	706998-3X	706049X	706053X	707074X	36113-1	36113-1
605175-5	Standard	3.54	706998-1X	706051X	706055X	706058X	36113-1	36113-1
605175-6	Powr Lok	3.54	706998-1X	706049X	706053X	707074X	36113-1	36113-1
605175-7	Standard	4.10	706998-3X	706051X	706055X	706058X	36113-1	36113-1
605175-8	Powr Lok	4.10	706998-3X	706049X	706053X	707074X	36113-1	36113-1
605175-9	Standard	3.54	706998-1X	706051X	706055X	706058X	36113-1	36113-1
605175-10	Powr Lok	3.54	706998-1X	706049X	706053X	707074X	36113-1	36113-1
605175-11	Standard	4.10	706998-3X	706051X	706055X	706058X	36113-1	36113-1
605175-12	Powr Lok	4.10	706998-3X	706049X	706053X	707074X	36113-1	36113-1
605175-13	Standard	4.56	706998-4X	706052X	706056X	706058X	36113-1	36113-1
605175-14	Standard	3.54	706998-1X	706051X	706055X	706058X	36113-1	36113-1
605175-15	Powr Lok	3.54	706998-1X	706049X	706053X	707074X	36113-1	36113-1
605175-16	Standard	4.10	706998-3X	706051X	706055X	706058X	36113-1	36113-1
605175-17	Powr Lok	4.10	706998-3X	706049X	706053X	707074X	36113-1	36113-1
605175-18	Standard	7.17	706999-15X	706052X	706056X	706058X	36113-1	36113-1
605175-19	Standard	4.56	706998-4X	706052X	706056X	706058X	36113-1	36113-1
605175-23	No Spin	7.17	706999-15X	28284X	706084X	35683	36113-1	36113-1
<b>1983 1/2 F-350 U-Haul - 70U</b>								
605206-1	Standard	4.10	706998-3X	706051X	706055X	706058X	36113-1	36113-1
605206-2	Standard	4.56	706998-4X	706052X	706056X	706058X	36113-1	36113-1
605206-3	Standard	4.10	706998-3X	706051X	706055X	706058X	36113-1	36113-1
<b>1983 1/2-85 F-350 Heavy Duty Chassis - 70HD</b>								
605176-1	Standard	4.10	706999-4X	706064X	706068X	706058X	36113-1	36113-1
605176-2	Standard	4.56	706999-6X	706065X	706069X	706058X	36113-1	36113-1
605176-3	Standard	4.10	706999-4X	706064X	706068X	706058X	36113-1	36113-1
605176-4	Standard	4.56	706999-6X	706065X	706069X	706058X	36113-1	36113-1
605176-5	Standard	4.10	706999-4X	706064X	706068X	706058X	36113-1	36113-1
605176-6	Standard	3.73	706999-2X	706064X	706068X	706058X	36113-1	36113-1
605176-7	Powr Lok	4.10	706999-4X	707028X <sup>(9)</sup>	707029X	707074X	36113-1	36113-1
605176-8	Powr Lok	4.56	706999-6X	706063X	706067X	707074X	36113-1	36113-1
605176-9	Standard	4.10	706999-4X	706064X	706068X	706058X	36113-1	36113-1
605176-10	Standard	3.54	706999-1X	706064X	706068X	706058X	36113-1	36113-1
605176-11	Powr Lok	4.10	706999-4X	707028X <sup>(9)</sup>	707029X	707074X	36113-1	36113-1
605176-12	Standard	4.56	706999-6X	706065X	706069X	706058X	36113-1	36113-1
605176-13	Powr Lok	4.56	706999-6X	706063X	706067X	707074X	36113-1	36113-1
605176-14	Standard	6.17	706999-12X	706065X	706069X	706058X	36113-1	36113-1
605176-15	Powr Lok	3.54	706999-1X	707028X	707029X	707074X	36113-1	36113-1
605176-16	Powr Lok	4.10	706999-4X	707028X	707029X	707074X	36113-1	36113-1
605176-17	Powr Lok	3.54	706999-1X	707028X	707029X	707074X	36113-1	36113-1
605176-18	Standard	4.56	706999-6X	706065X	706069X	706058X	36113-1	36113-1

(7) See Ring Gear &amp; Pinion Kits in XGI Catalog for ratio &amp; tooth combinations.

(8) See Differential Case Assy Kits in XGI Catalog for spline data &amp; ratios.

(9) May require 34848-10 &amp; 34848-28 differential bearing spacers.

# Ford Model 70 /267 Rear Axles

## Bill of Material Table

Axle			Axle Kits				Shaft & Joint Assy.	
Bill of Material	Diff. Type	Ratio	Ring Gear & Pinion Kit <sup>(7)</sup>	Differential			Right Hand Shaft Assy.	Left Hand Shaft Assy.
				Case Assy. Kit <sup>(8)</sup>	Case Kit	Inner Parts Kit		
<b>1983 1/2-85 F-350 - 70U</b>								
605205-1	Standard	4.10	706998-3X	706051X	706055X	706058X	36113-23	36113-22
605205-2	Powr Lok	4.10	706998-3X	706049X	706053X	707074X	36113-23	36113-22
605205-3	Standard	3.54	706998-1X	706051X	706055X	706058X	36113-23	36113-22
605205-4	Powr Lok	3.54	706998-1X	706049X	706053X	707074X	36113-23	36113-22
605205-5	Standard	3.54	706998-1X	706051X	706055X	706058X	36113-23	36113-22
605205-6	Powr Lok	3.54	706998-1X	706049X	706053X	707074X	36113-23	36113-22
605205-7	Standard	4.10	706998-3X	706051X	706055X	706058X	36113-23	36113-22
605205-8	Powr Lok	4.10	706998-3X	706049X	706053X	707074X	36113-23	36113-22
605205-9	Standard	4.56	706998-4X	706052X	706056X	706058X	36113-23	36113-22
605205-10	No Spin	4.56	706998-4X	28284X	706631X	35683	36113-23	36113-22
<b>1983 1/2-85 F-350 Pick-Up - 70U</b>								
605204-1	Standard	4.10	706998-3X	706051X	706055X	707074X	36113-7	36113-21
605204-2	Powr Lok	4.10	706998-3X	706049X	706053X	707074X	36113-7	36113-21
605204-3	Standard	3.54	706998-1X	706051X	706055X	706058X	36113-7	36113-21
605204-4	Powr Lok	3.54	706998-1X	706049X	706053X	707074X	36113-7	36113-21
605204-5	Standard	3.54	706998-1X	706051X	706055X	706058X	36113-7	36113-21
605204-6	Powr Lok	3.54	706998-1X	706049X	706053X	707074X	36113-7	36113-21
605204-7	Standard	4.10	706998-3X	706051X	706055X	706058X	36113-7	36113-21
605204-8	Powr Lok	4.10	706998-3X	706049X	706053X	707074X	36113-7	36113-21
<b>1983 1/2-85 F-350 DSO Ambulance - 70HD</b>								
605207-1	Powr Lok	4.10	706999-4X	707028X <sup>(9)</sup>	707029X	707074X	36113-17	36113-17
605207-2	Standard	3.73	706999-2X	706064X	706068X	706058X	36113-17	36113-17
605207-3	Powr Lok	3.73	706999-2X	707028X <sup>(9)</sup>	707029X	707074X	36113-17	36113-17
605207-4	Standard	4.10	706999-4X	706064X	706068X	706058X	36113-17	36113-17
605207-5	Standard	3.54	706999-1X	706064X	706068X	706058X	36113-17	36113-17
605207-6	Powr Lok	4.10	706999-4X	707028X <sup>(9)</sup>	707029X	707074X	36113-17	36113-17
605207-7	Standard	3.73	706999-2X	706064X	706068X	706058X	36113-17	36113-17
605207-8	Powr Lok	3.73	706999-2X	707028X <sup>(9)</sup>	707029X	707074X	36113-17	36113-17
605207-9	Standard	4.10	706999-4X	706064X	706068X	706058X	36113-17	36113-17
605207-10	Standard	3.54	706999-1X	706064X	706068X	706058X	36113-17	36113-17
605207-11	Powr Lok	4.10	706999-4X	707028X <sup>(9)</sup>	707029X	707074X	36113-17	36113-17
605207-12	Standard	3.73	706999-2X	706064X	706068X	706058X	36113-17	36113-17
605207-13	Powr Lok	3.73	706999-2X	707028X <sup>(9)</sup>	707029X	707074X	36113-17	36113-17
605207-14	Standard	4.10	706999-4X	706064X	706068X	706058X	36113-17	36113-17
605207-15	Standard	3.54	706999-1X	706064X	706068X	706058X	36113-17	36113-17
<b>1984-85 E-350 - 70U</b>								
605213-1	Standard	3.54	706998-1X	706051X	706055X	706058X	36113-8	36113-6
605213-2	Powr Lok	3.54	706998-1X	706049X	706053X	707074X	36113-8	36113-6
605213-3	Powr Lok	3.73	706998-2X	706049X	706053X	707074X	36113-8	36113-6
605213-4	Standard	4.10	706998-3X	706051X	706055X	706058X	36113-8	36113-6
605213-5	Powr Lok	4.10	706998-3X	706049X	706053X	707074X	36113-8	36113-6
605213-6	Standard	3.54	706998-1X	706051X	706055X	706058X	36113-8	36113-6
605213-7	Powr Lok	3.54	706998-1X	706049X	706053X	707074X	36113-8	36113-6
605213-8	Powr Lok	3.73	706998-2X	706049X	706053X	707074X	36113-8	36113-6
605213-9	Standard	4.10	706998-3X	706051X	706055X	706058X	36113-8	36113-6
605213-10	Powr Lok	4.10	706998-3X	706049X	706053X	707074X	36113-8	36113-6
605213-11	Standard	7.17	706998-9X	706052X	706056X	706058X	36113-8	36113-6
605213-12	Standard	4.56	706998-4X	706052X	706056X	706058X	36113-8	36113-6

(7) See Ring Gear & Pinion Kits in XGI Catalog for ratio & tooth combinations.

(8) See Differential Case Assy Kits in XGI Catalog for spline data & ratios.

(9) May require 34848-10 & 34848-28 differential bearing spacers.

# Ford Model 70 /267 Rear Axles

## Bill of Material Table

Axle			Axle Kits				Shaft & Joint Assy.	
Bill of Material	Diff. Type	Ratio	Ring Gear & Pinion Kit <sup>(7)</sup>	Differential			Right Hand Shaft Assy.	Left Hand Shaft Assy.
				Case Assy. Kit <sup>(8)</sup>	Case Kit	Inner Parts Kit		
<b>1984-85 F-350 Big Dooley - 70HD</b>								
605170-1	Standard	4.10	706999-4X	706064X	706068X	706058X	36113-18	36113-19
605170-2	Powr Lok	4.10	706999-4X	707028X <sup>(9)</sup>	707029X	707074X	36113-18	36113-19
605170-3	Standard	4.56	706999-6X	706065X	706069X	706058X	36113-18	36113-19
605170-5	Standard	3.54	706999-1X	706064X	706068X	706058X	36113-18	36113-19
605170-6	Powr Lok	3.54	706999-1X	707028X <sup>(9)</sup>	707029X	707074X	36113-18	36113-19
605170-7	Standard	4.10	706999-4X	706064X	706068X	706058X	36113-18	36113-19
605170-8	Powr Lok	4.10	706999-4X	707028X <sup>(9)</sup>	707029X	707074X	36113-18	36113-19
605170-9	Standard	4.56	706999-6X	706065X	706069X	706058X	36113-18	36113-19
605170-11	Standard	3.54	706999-1X	706064X	706068X	706058X	36113-18	36113-19
605170-12	Powr Lok	3.54	706999-1X	707028X <sup>(9)</sup>	707029X	707074X	36113-18	36113-19
605170-13	Standard	3.54	706999-1X	706064X	706068X	706058X	36113-18	36113-19
605170-14	Powr Lok	3.54	706999-1X	707028X <sup>(9)</sup>	707029X	707074X	36113-18	36113-19
605170-15	Standard	4.10	706999-4X	706064X	706068X	706058X	36113-18	36113-19
605170-16	Powr Lok	4.10	706999-4X	707028X <sup>(9)</sup>	707029X	707074X	36113-18	36113-19
605170-17	Standard	3.54	706999-1X	706064X	706068X	706058X	36113-18	36113-19
605170-18	Powr Lok	3.54	706999-1X	707028X <sup>(9)</sup>	707029X	707074X	36113-18	36113-19
605170-19	Standard	4.10	706999-4X	706064X	706068X	706058X	36113-18	36113-19
605170-20	Powr Lok	4.10	706999-4X	707028X <sup>(9)</sup>	707029X	707074X	36113-18	36113-19
<b>1984-85 F-350 - 70U</b>								
605208-1	Standard	3.54	706998-1X	706051X	706055X	706058X	36113-1	36113-1
605208-2	Powr Lok	3.54	706998-1X	706049X	706053X	707074X	36113-1	36113-1
605208-3	Standard	4.10	706998-3X	706051X	706055X	706058X	36113-1	36113-1
605208-4	Powr Lok	4.10	706998-3X	706049X	706053X	707074X	36113-1	36113-1
605208-5	Standard	3.54	706998-1X	706051X	706055X	706058X	36113-1	36113-1
605208-6	Powr Lok	3.54	706998-1X	706049X	706053X	707074X	36113-1	36113-1
605208-7	Standard	4.10	706998-3X	706051X	706055X	706058X	36113-1	36113-1
605208-8	Powr Lok	4.10	706998-3X	706049X	706053X	707074X	36113-1	36113-1
605208-9	Powr Lok	7.17	706998-10X	706050X	706054X	707074X	36113-1	36113-1
605208-10	Standard	7.17	706998-9X	706052X	706056X	706058X	36113-1	36113-1
605208-11	Standard	4.56	706998-4X	706052X	706056X	706058X	36113-1	36113-1
<b>1985 F-350 - 70U</b>								
605246-1	Standard	3.54	706998-1X	706051X	706055X	706058X	36113-7	36113-21
605246-2	Standard	4.10	706998-3X	706051X	706055X	706058X	36113-7	36113-21
605246-3	Powr Lok	4.10	706998-3X	707026X	706053X	707074X	36113-7	36113-21
605246-4	Standard	4.56	706998-4X	706052X	706056X	706058X	36113-7	36113-21
605247-1	Standard	3.54	706998-1X	706051X	706055X	706058X	36113-23	36113-22
605247-2	Powr Lok	3.54	706998-1X	707026X	706053X	707074X	36113-23	36113-22
605247-3	Standard	4.10	706998-3X	706051X	706055X	706058X	36113-23	36113-22
605247-4	Powr Lok	4.10	706998-3X	707026X	706053X	707074X	36113-23	36113-22
605248-1	Standard	3.54	706998-1X	706051X	706055X	706058X	36113-1	36113-1
605248-2	Powr Lok	3.54	706998-1X	707026X	706053X	707074X	36113-1	36113-1
605248-3	Standard	4.10	706998-3X	706051X	706055X	706058X	36113-1	36113-1
605248-4	Powr Lok	4.10	706998-3X	707026X	706053X	707074X	36113-1	36113-1
605248-5	Standard	4.56	706998-4X	706052X	706056X	706058X	36113-1	36113-1
605248-6	Standard	4.56	706998-4X	706052X	706056X	706058X	36113-1	36113-1
605248-7	Standard	7.17	706998-9X	706052X	706056X	706058X	36113-1	36113-1

(7) See Ring Gear &amp; Pinion Kits in XGI Catalog for ratio &amp; tooth combinations.

(8) See Differential Case Assy Kits in XGI Catalog for spline data &amp; ratios.

(9) May require 34848-10 &amp; 34848-28 differential bearing spacers.

# Ford Model 70 /267 Rear Axles

## Bill of Material Table

Axle			Axle Kits				Shaft & Joint Assy.	
Bill of Material	Diff. Type	Ratio	Ring Gear & Pinion Kit <sup>(7)</sup>	Differential			Right Hand Shaft Assy.	Left Hand Shaft Assy.
				Case Assy. Kit <sup>(8)</sup>	Case Kit	Inner Parts Kit		
<b>1985 F-350 Big Dooley - 70HD</b>								
605250-1	Standard	3.54	706999-1X	706064X	706068X	706058X	36113-18	36113-19
605250-2	Standard	4.10	706999-4X	706064X	706068X	706058X	36113-18	36113-19
605250-3	Powr Lok	4.10	706999-4X	707028X <sup>(9)</sup>	707029X	707074X	36113-18	36113-19
<b>1985 F-350 Heavy Duty Chassis - 70HD</b>								
605249-1	Standard	4.10	706999-4X	706064X	706068X	706058X	36113-1	36113-1
605249-2	Standard	3.54	706999-1X	706064X	706068X	706058X	36113-1	36113-1
605249-3	Powr Lok	4.56	706999-6X	706063X	706730X	707074X	36113-1	36113-1
605249-4	Powr Lok	4.10	706999-4X	707028X <sup>(9)</sup>	707029X	707074X	36113-1	36113-1
605249-5	No Spin	4.56	706999-6X	26996X	706098X	35683	36113-1	36113-1
605249-6	Standard	6.17	706999-12X	706065X	706069X	706058X	36113-1	36113-1
605249-7	Standard	4.56	706999-6X	706065X	706069X	706058X	36113-1	36113-1
<b>1985-86 E-350 - 70U</b>								
605253-1	Standard	3.54	706998-1X	706051X	706055X	706058X	36113-8	36113-6
605253-2	Standard	4.10	706998-3X	706051X	706055X	706058X	36113-8	36113-6
605253-3	Powr Lok	4.10	706998-3X	707026X	706053X	707074X	36113-8	36113-6
605253-4	Standard	4.56	706998-4X	706052X	706056X	706058X	36113-8	36113-6
605253-5	Standard	5.13	706998-6X	706052X	706056X	706058X	36113-8	36113-6
<b>1985-87 F-350 - DSO Ambulance - 70HD</b>								
605255-1	Standard	3.54	706999-1X	706064X	706068X	706058X	36113-17	36113-17
605255-2	Powr Lok	3.54	706999-1X	707028X <sup>(9)</sup>	707029X	707074X	36113-17	36113-17
605255-3	Standard	3.73	706999-2X	706064X	706068X	706058X	36113-17	36113-17
605255-4	Powr Lok	3.73	706999-2X	707028X <sup>(9)</sup>	707029X	707074X	36113-17	36113-17
605255-5	Standard	4.10	706999-4X	706064X	706068X	706058X	36113-17	36113-17
605255-6	Powr Lok	4.10	706999-4X	707028X <sup>(9)</sup>	707029X	707074X	36113-17	36113-17
<b>1987-88 E-350 - DRW - 70U</b>								
605300-1	Standard	3.54	706998-1X	706051X	706055X	706058X	36113-27	36113-28
605300-2	Standard	4.10	706998-3X	706051X	706055X	706058X	36113-27	36113-28
605300-3	Powr Lok	4.10	706998-3X	707073X	706053X	707074X	36113-27	36113-28
605300-4	Standard	4.56	706998-4X	706052X	706056X	706058X	36113-27	36113-28
605300-5	Powr Lok	3.54	706998-1X	707073X	706053X	707074X	36113-27	36113-28
<b>1987 1/2 E-350 - DRW - 70HD</b>								
605344-1	Standard	4.10	706999-4X	706064X	706068X	706058X	36113-27	36113-28
605344-2	Standard	3.54	706999-1X	706064X	706068X	706058X	36113-27	36113-28
605344-3	Powr Lok	3.54	706999-1X	707088X	707029X	707074X	36113-27	36113-28
605344-4	Powr Lok	4.10	706999-4X	707088X	707029X	707074X	36113-27	36113-28
<b>1987 1/2 E-350 - DRW - 70U</b>								
605352-1	Standard	4.10	706998-3X	706051X	706055X	706058X	36113-27	36113-28
605352-2	Standard	4.56	706998-4X	706052X	706056X	706058X	36113-27	36113-28
<b>1988 1/2-89 E-350 U-Haul - 70HD</b>								
605337-1	Standard	3.54	706999-1X	706064X	706068X	706058X	36113-27	36113-28
605337-2	Standard	4.10	706999-4X	706064X	706068X	706058X	36113-27	36113-28
<b>1989 E-350 - DRW - 70U</b>								
605412-1	Standard	3.54	706998-1X	707215X	707216X	706058X	36113-27	36113-28
605412-2	Standard	4.10	706998-3X	707215X	707216X	706058X	36113-27	36113-28
605412-3	Powr Lok	4.10	706998-3X	707145X	707146X	707074X	36113-27	36113-28
605412-4	Standard	4.56	706998-4X	707176X	707177X	706058X	36113-27	36113-28

(7) See Ring Gear & Pinion Kits in XGI Catalog for ratio & tooth combinations.  
(8) See Differential Case Assy Kits in XGI Catalog for spline data & ratios.  
(9) May require 34848-10 & 34848-28 differential bearing spacers.



## Ford Model 70 /267 Rear Axles Bill of Material Table

Axle			Axle Kits				Shaft & Joint Assy.	
Bill of Material	Diff. Type	Ratio	Ring Gear & Pinion Kit <sup>(7)</sup>	Differential			Right Hand Shaft Assy.	Left Hand Shaft Assy.
				Case Assy. Kit <sup>(8)</sup>	Case Kit	Inner Parts Kit		
<b>1989-90 E-350 Motor Home - 70HD</b>								
605438-1	Standard	4.10	706999-4X	706064X	706068X	706058X	36113-27	36113-28
605438-2	Standard	3.54	706999-1X	706064X	706068X	706058X	36113-27	36113-28
605438-3	Powr Lok	3.54	706999-1X	707088X	707029X	707074X	36113-27	36113-28
605438-4	Powr Lok	4.10	706999-4X	707088X	707029X	707074X	36113-27	36113-28
<b>1989-90 1/2 E-350 Motor Home - 70U</b>								
605437-1	Standard	4.10	706998-3X	707215X	707216X	706058X	36113-27	36113-28
605437-2	Standard	4.56	706998-4X	707176X	707177X	706058X	36113-27	36113-28
<b>1990-91 1/2 E-350 - DRW - ABS - 70U</b>								
605421-1	Standard	3.54	706998-1X	707215X	707216X	706058X	36113-27	36113-28
605421-2	Standard	4.10	706998-3X	707215X	707216X	706058X	36113-27	36113-28
605421-3	Powr Lok	4.10	706998-3X	707145X	707146X	707074X	36113-27	36113-28
<b>1990-91 1/2 UPS - ABS - 70U</b>								
605518-1	Standard	4.10	706998-3X	707241X	707216X	707119X	36113-27	36113-28
<b>1990-91 1/2 E-350 Motor Home - ABS - 70HD</b>								
605471-1	Standard	4.10	706999-4X	707186X	707187X	706058X	36113-27	36113-28
605471-2	Standard	3.54	706999-1X	707186X	707187X	706058X	36113-27	36113-28
605471-3	Powr Lok	3.54	706999-1X	707189X	707188X	707074X	36113-27	36113-28
605471-4	Powr Lok	4.10	706999-4X	707189X	707188X	707074X	36113-27	36113-28
<b>1990-91 1/2 E-350 U-Haul - ABS - 70HD</b>								
605480-1	Standard	3.54	706999-1X	707186X	707187X	706058X	36113-27	36113-28
605480-2	Standard	4.10	706999-4X	707186X	707187X	706058X	36113-27	36113-28
<b>1991-91 1/2 Continental Bakery Chassis - ABS - 70U</b>								
605501-1	Standard	3.54	706998-1X	707215X	707216X	706058X	36113-27	36113-28
605501-2	Standard	4.10	706998-3X	707215X	707216X	706058X	36113-27	36113-28
<b>1992 Continental Bakery - ABS - 70U</b>								
605537-2	Standard	4.10	706998-3X	707215X	707216X	706058X	36113-27	36113-28
<b>1992 E-350 - DRW - ABS - 70U</b>								
605488-1	Standard	3.54	706998-1X	707215X	707216X	706058X	36113-27	36113-28
605488-2	Standard	4.10	706998-3X	707215X	707216X	706058X	36113-27	36113-28
605488-3	Powr Lok	4.10	706998-3X	707145X	707146X	707074X	36113-27	36113-28
<b>1992-92 1/2 UPS - ABS - 70U</b>								
605540-1	Standard	4.10	706998-3X	707241X	707216X	707119X	36113-27	36113-28
<b>1992-93 1/2 E-350 Motor Home - ABS - 70HD</b>								
605538-1	Standard	4.10	706999-4X	707186X	707187X	706058X	36113-27	36113-28
605538-2	Standard	3.54	706999-1X	707186X	707187X	706058X	36113-27	36113-28
605538-3	Powr Lok	3.54	706999-1X	707189X	707188X	707074X	36113-27	36113-28
605538-4	Powr Lok	4.10	706999-4X	707189X	707188X	707074X	36113-27	36113-28
605538-5	Standard	4.10	706999-4X	707186X	707187X	706058X	36113-27	36113-28
605538-6	Standard	3.54	706999-1X	707186X	707187X	706058X	36113-27	36113-28
605538-7	Powr Lok	3.54	706999-1X	707189X	707188X	707074X	36113-27	36113-28
605538-8	Powr Lok	4.10	706999-4X	707189X	707188X	707074X	36113-27	36113-28
605538-9	Standard	4.10	706999-4X	707186X	707187X	706058X	36113-27	36113-28
605538-10	Powr Lok	4.10	706999-4X	707189X	707188X	707074X	36113-27	36113-28
<b>1992-93 1/2 E-350 U-Haul - ABS - 70HD</b>								
605539-1	Standard	3.54	706999-1X	707186X	707187X	706058X	36113-27	36113-28
605539-2	Standard	4.10	706999-4X	707186X	707187X	706058X	36113-27	36113-28

(7) See Ring Gear &amp; Pinion Kits in XGI Catalog for ratio &amp; tooth combinations.

(8) See Differential Case Assy Kits in XGI Catalog for spline data &amp; ratios.

(9) May require 34848-10 &amp; 34848-28 differential bearing spacers.



# Ford Model 70 /267 Rear Axles

## Bill of Material Table

Axle			Axle Kits				Shaft & Joint Assy.	
Bill of Material	Diff. Type	Ratio	Ring Gear & Pinion Kit <sup>(7)</sup>	Differential			Right Hand Shaft Assy.	Left Hand Shaft Assy.
				Case Assy. Kit <sup>(8)</sup>	Case Kit	Inner Parts Kit		
<b>1992 1/2-93 1/2 Continental Bakery - ABS - 70U</b>								
605583-1	Standard	4.10	706998-3X	707276X	707216X	707252X	43811-4	43811-7
<b>1992 1/2-93 1/2 UPS - ABS - 70U</b>								
605584-1	Standard	4.10	706998-3X	707312X	707216X	707313X	43811-4	43811-7
<b>1992 1/2-93 1/2 E-350 - DRW - ABS - 70U</b>								
605567-1	Standard	3.54	706998-1X	707276X	707216X	707252X	43811-4	43811-7
605567-2	Standard	4.10	706998-3X	707276X	707216X	707252X	43811-4	43811-7
605567-3	Powr Lok	4.10	706998-3X	707277X	707146X	707254X	43811-4	43811-7
605567-4	Standard	3.54	706998-1X	707276X	707216X	707252X	43811-4	43811-7
605567-5	Standard	4.10	706998-3X	707276X	707216X	707252X	43811-4	43811-7
605567-6	Powr Lok	4.10	706998-3X	707277X	707146X	707254X	43811-4	43811-7
<b>1992 1/2-93 1/2 E-350 SRW Cutaway, Wide Track - ABS - 70 2U</b>								
605578-1	Standard	4.10	706998-3X	707276X	707216X	707252X	43811-4	43811-7
605578-2	Powr Lok	4.10	706998-3X	707277X	707146X	707254X	43811-4	43811-7
<b>1993 1/2-94 E-350 - DRW - ABS - 70U</b>								
605608-1	Standard	4.10	706998-3X	707276X	707216X	707252X	43811-4	43811-7
605608-2	Powr Lok	4.10	706998-3X	707277X	707146X	707254X	43811-4	43811-7
605665-1	Standard	4.10	706999-4X	707186X	707187X	706058X	36113-27	36113-28
605666-1	Standard	4.10	706999-4X	707186X	707187X	706058X	36113-27	36113-28
<b>1993 1/2-94 E-350 Motor Home - ABS - 70HD</b>								
605609-1	Standard	4.10	706999-4X	707186X	707187X	706058X	36113-27	36113-28
605609-2	Powr Lok	4.10	706999-4X	707189X	707188X	707074X	36113-27	36113-28
<b>1993 1/2-94 E-350 SRW Cutaway, Wide Track - ABS - 70 2U</b>								
605669-1	Standard	4.10	706998-3X	707276X	707216X	707252X	43811-4	43811-7
<b>1993 1/2-94 1/2 E-350 - DRW - ABS - 70U</b>								
605667-1	Standard	4.10	706999-4X	707186X	707187X	706058X	36113-27	36113-28
<b>1994 E-350 - DRW - ABS - 70U</b>								
605671-1	Standard	4.10	706998-3X	707276X	707216X	707252X	43811-4	43811-7
605671-2	Powr Lok	4.10	706998-3X	707277X	707146X	707254X	43811-4	43811-7
<b>1994 E-350 - DRW - ABS - 70HD</b>								
605692-1	Standard	4.10	706999-4X	707186X	707187X	706058X	36113-27	36113-28
605693-1	Standard	4.10	706999-4X	707186X	707187X	706058X	36113-27	36113-28
<b>1994-94 1/2 E-350 - ABS - 70U</b>								
605640-1	Standard	4.10	706998-3X	707312X	707216X	707313X	43811-4	43811-7
<b>1994-94 1/2 E-350 - DRW - ABS - 70U</b>								
605673-1	Standard	4.10	706998-3X	707276X	707216X	707252X	43811-4	43811-7
605673-2	Powr Lok	4.10	706998-3X	707277X	707146X	707254X	43811-4	43811-7
<b>1994-94 1/2 E-350 Motor Home - ABS - 70HD</b>								
605672-1	Standard	4.10	706999-4X	707186X	707187X	706058X	36113-27	36113-28
605672-2	Powr Lok	4.10	706999-4X	707189X	707188X	707074X	36113-27	36113-28
605675-1	Standard	4.10	706999-4X	707186X	707187X	706058X	36113-27	36113-28
605675-2	Powr Lok	4.10	706999-4X	707189X	707188X	707074X	36113-27	36113-28
<b>1994 1/2-95 E-350 - DRW - ABS - 70HD</b>								
605714-1	Standard	4.10	706998-3X	707276X	707216X	707252X	43811-4	43811-7
605714-2	Powr Lok	4.10	706998-3X	707277X	707146X	707254X	43811-4	43811-7

(7) See Ring Gear & Pinion Kits in XGI Catalog for ratio & tooth combinations.

(8) See Differential Case Assy Kits in XGI Catalog for spline data & ratios.

# Ford Model 70 /267 Rear Axles

## Bill of Material Table

Axle			Axle Kits				Shaft & Joint Assy.	
Bill of Material	Diff. Type	Ratio	Ring Gear & Pinion Kit <sup>(7)</sup>	Differential			Right Hand Shaft Assy.	Left Hand Shaft Assy.
				Case Assy. Kit <sup>(8)</sup>	Case Kit	Inner Parts Kit		
<b>1994 1/2-95 E-350 Motor Home - ABS - 70HD</b>								
605715-1	Standard	4.10	706999-4X	707186X	707187X	706058X	36113-27	36113-28
605715-2	Powr Lok	4.10	706999-4X	707189X	707188X	707074X	36113-27	36113-28
<b>1995-95 1/2 E-350 - DRW - ABS - 70U</b>								
605687-1	Standard	4.10	706998-3X	707276X	707216X	707252X	43811-4	43811-7
605687-2	Powr Lok	4.10	706998-3X	707277X	707146X	707254X	43811-4	43811-7
605687-3	Standard	4.10	706998-3X	707276X	707216X	707252X	43811-4	43811-7
605687-4	Powr Lok	4.10	706998-3X	707277X	707146X	707254X	43811-4	43811-7
605689-1	Standard	4.10	706998-3X	707276X	707216X	707252X	43811-4	43811-7
605689-2	Powr Lok	4.10	706998-3X	707277X	707146X	707254X	43811-4	43811-7
605689-3	Standard	4.10	706998-3X	707276X	707216X	707252X	43811-4	43811-7
605689-4	Powr Lok	4.10	706998-3X	707277X	707146X	707254X	43811-4	43811-7
605845-1	Standard	4.10	706998-3X	707276X	707216X	707252X	43811-4	43811-7
605845-2	Powr Lok	4.10	706998-3X	707277X	707146X	707254X	43811-4	43811-7
<b>1995-95 1/2 E-350 SRW Cutaway, Wide Track - ABS - 70 2U</b>								
605686-1	Standard	4.10	706998-3X	707276X	707216X	707252X	43811-4	43811-7
605686-2	Powr Lok	4.10	706998-3X	707277X	707146X	707254X	43811-4	43811-7
605686-3	Standard	4.10	706998-3X	707276X	707216X	707252X	43811-4	43811-7
605686-4	Powr Lok	4.10	706998-3X	707277X	707146X	707254X	43811-4	43811-7
605844-1	Standard	4.10	706998-3X	707276X	707216X	707252X	43811-4	43811-7
605844-2	Powr Lok	4.10	706998-3X	707277X	707146X	707254X	43811-4	43811-7
<b>1995-95 1/2 E-350 Motor Home - 70HD</b>								
605688-1	Standard	4.10	706999-4X	707186X	707187X	706058X	36113-27	36113-28
605688-2	Powr Lok	4.10	706999-4X	707189X	707188X	707074X	36113-27	36113-28
605688-3	Standard	4.10	706999-4X	707186X	707187X	706058X	36113-27	36113-28
605688-4	Powr Lok	4.10	706999-4X	707189X	707188X	707074X	36113-27	36113-28
<b>1995-95 1/2 E-350 Motor Home - ABS - 70HD</b>								
605690-1	Standard	4.10	706999-4X	707186X	707187X	706058X	36113-27	36113-28
605690-2	Powr Lok	4.10	706999-4X	707189X	707188X	707074X	36113-27	36113-28
605690-3	Standard	4.10	706999-4X	707186X	707187X	706058X	36113-27	36113-28
605690-4	Powr Lok	4.10	706999-4X	707189X	707188X	707074X	36113-27	36113-28
<b>1996 E-350 Motor Home - ABS - 70HD</b>								
605929-1	Standard	4.10	706999-4X	707186X	707187X	706058X	36113-27	36113-28
<b>1996-97 E-350 Motor Home - ABS - 70HD</b>								
605846-1	Standard	4.10	706999-4X	707186X	707187X	706058X	36113-27	36113-28
605846-2	Powr Lok	4.10	706999-4X	707189X	707188X	707074X	36113-27	36113-28
605848-1	Standard	4.10	706999-4X	707186X	707187X	706058X	36113-27	36113-28
605848-2	Powr Lok	4.10	706999-4X	707189X	707188X	707074X	36113-27	36113-28
<b>1996-97 E-350 - DRW - ABS - 70U</b>								
605847-1	Standard	4.10	706998-3X	707276X	707216X	707252X	43811-4	43811-7
605847-2	Powr Lok	4.10	706998-3X	707277X	707146X	707254X	43811-4	43811-7
605860-1	Standard	3.73	706998-2X	707276X	707216X	707252X	43811-4	43811-7
605861-1	Standard	3.73	706998-2X	707276X	707216X	707252X	43811-4	43811-7
605862-1	Standard	4.10	706999-4X	707186X	707187X	706058X	36113-27	36113-28

(7) See Ring Gear &amp; Pinion Kits in XGI Catalog for ratio &amp; tooth combinations.

(8) See Differential Case Assy Kits in XGI Catalog for spline data &amp; ratios.

# Ford Model 70 /267 Rear Axles

## Bill of Material Table

Axle			Axle Kits				Shaft & Joint Assy.	
Bill of Material	Diff. Type	Ratio	Ring Gear & Pinion Kit <sup>(7)</sup>	Differential			Right Hand Shaft Assy.	Left Hand Shaft Assy.
				Case Assy. Kit <sup>(8)</sup>	Case Kit	Inner Parts Kit		
<b>1997 E-350 - DRW - ABS - 70U</b>								
605951-1	Standard	4.10	707407-1X	707276-1X	707216X	707252X	43811-4	43811-7
605951-2	Powr Lok	4.10	707407-1X	707277-1X	707146-1X	707254X	43811-4	43811-7
<b>1997 E-350 SRW Cutaway, Wide Track - ABS - 70 2U</b>								
605950-1	Standard	4.10	707407-1X	707276-1X	707216-1X	707252X	43811-4	43811-7
605950-2	Powr Lok	4.10	707407-1X	707277-1X	707146-1X	707254X	43811-4	43811-7
<b>1997 1/2-98 1/2 E-350 - DRW</b>								
606028-1	Standard	4.10	707482-1X	707483X	707484X	706058X	36113-27	36113-28
606028-2	Standard	4.56	707482-2X	707483X	707484X	706058X	36113-27	36113-28
<b>1998 E350 - DRW - ABS</b>								
606160-1	Standard	4.10	707482-1X	707483X	707484X	706058X	36113-27	36113-28
<b>1998-98 1/2 E-350 - DRW - ABS - 70U</b>								
606021-1	Standard	4.10	707407-1X	707276-1X	707216-1X	707252X	43811-4	43811-7
606021-2	Powr Lok	4.10	707407-1X	707277-1X	707146-1X	707254X	43811-4	43811-7
<b>1998-98 1/2 E-350 SRW Cutaway, Wide Track - ABS - 70U</b>								
606020-1	Standard	4.10	707407-1X	707276-1X	707216-1X	707252X	43811-4	43811-7
606020-2	Powr Lok	4.10	707407-1X	707277-1X	707146-1X	707254X	43811-4	43811-7
<b>1998 1/2 E-350 DRW - Full Float - ABS</b>								
606159-1	Standard	4.10	707407-1X	707276-1X	707216-1X	707252X	43811-4	43811-7
606159-2	Powr Lok	4.10	707407-1X	707277-1X	707146-1X	707254X	43811-4	43811-7
<b>1998 1/2-99 E-350 Cutaway SRW or DRW Option - ABS</b>								
606158-1	Standard	4.10	707407-1X	707276X	707216X	707252X	43811-4	43811-7
606158-2	Powr Lok	4.10	707407-1X	707277-1X	707146-1X	707254X	43811-4	43811-7

(7) See Ring Gear & Pinion Kits in XGI Catalog for ratio & tooth combinations.

(8) See Differential Case Assy Kits in XGI Catalog for spline data & ratios.

# Ford Model 70 /267 Rear Axles

## Variable Parts Listing

Kits & Parts - Use With All Applications							
Description & Item Number (Refer to "Exploded View" at the front of this section)			Bills of Material				
			603909	603934	603935	603936	603937 603938
1	KIT – Inner Pinion Bearing	3	706060X	706060X	706060X	706060X	706060X
2	PKG – Pinion Bearing Shim	-	706357X	706357X	706357X	706357X	706357X
3	Baffle – Pinion Bearing	5	34849	—	—	—	—
4	PKG – Diff & Pinion Bearing Shim	-	706213X	706213X	706213X	706213X	706213X
5	End Yoke Assembly (inc 11)	10	3-4-5731X	2-4-5311X	3-4-5731X	3-4-5731X	2-4-5311X
6	Slinger – End Yoke	11	34592	34592	34592	34592	34592
7	Companion Flange Assembly	14	—	—	—	—	—
8	KIT – Carrier Cover	-	706059X	707104X	707104X	707104X	707104X
9	Carrier Cover	15	34055	42815-2	42815-2	42815-2	42815-2
10	Plug – Carrier Cover	17	36472	43180	43180	43180	43180
11	Bolt – Carrier Cover (qty 10)	18	34822	34822	34822	34822	34822
12	KIT – Differential Bearing	21	706070X	706047X	706047X	706047X	706047X
13	PKG – Diff Bearing Shim (inc 16)	22	708012	708012	708012	708012	708012
14	Bolt – Drive Gear (qty 12)	24	30266	30266	30266	30266	30266
15	Gear – Differential (std)	26	35079	35079	35079	35079	35079
16	Spacer – Differential Bearing	30	—	—	—	—	—
17	Tone Ring	31	—	—	—	—	—
18	Seal – Hub	34	46004	46004	46004	46004	46004
19	KIT – Inner Wheel Bearing	35	—	—	—	—	—
20	KIT – Outer Wheel Bearing	36	—	—	—	—	—
21	Spindle Nut / Wheel Bearing Retainer	38	—	—	—	—	—
22	Wheel Bearing Retainer (Left Hand)	-	—	—	—	—	—
23	Locking Wedge	39	—	—	—	—	—
24	Gear – Differential (p/l)	48	35294	35294	35294	—	35294
25	Lockwasher	51	36526	36526	36526	36526	36526
26	Screw – Flange Head	52	39694	39694	39694	39694	39694
			<b>603940</b>	<b>603949</b>	<b>603962</b>	<b>605038</b>	<b>605042</b>
1	KIT – Inner Pinion Bearing	3	706060X	706060X	706060X	706060X	706060X
2	PKG – Pinion Bearing Shim	-	706357X	706357X	706357X	706357X	706357X
3	Baffle – Pinion Bearing	5	—	—	—	—	—
4	PKG – Diff & Pinion Bearing Shim	-	706213X	706213X	706213X	706213X	706213X
5	End Yoke Assembly (inc 11)	10	3-4-5731X	2-4-5311X	2-4-5311X	2-4-8051X	2-4-5311X
6	Slinger – End Yoke	11	34592	34592	34592	41195	34592
7	Companion Flange Assembly	14	—	—	—	—	—
8	KIT – Carrier Cover	-	707104X	707104X	707104X	707104X	707104X
9	Carrier Cover	15	42815-2	42815-2	42815-2	42815-2	42815-2
10	Plug – Carrier Cover	17	43180	43180	43180	43180	43180
11	Bolt – Carrier Cover (qty 10)	18	34822	34822	34822	34822	34822
12	KIT – Differential Bearing	21	706070X	706070X	706047X	706047X	706047X
13	PKG – Diff Bearing Shim (inc 16)	22	708012	708012	708012	708012	708012
14	Bolt – Drive Gear (qty 12)	24	30266	30266	30266	30266	30266
15	Gear – Differential (std)	26	35079	35079	35079	35079	35079
16	Spacer – Differential Bearing	30	—	—	—	—	—
17	Tone Ring	31	—	—	—	—	—
18	Seal – Hub	34	46004	46004	46004	46004	46004
19	KIT – Inner Wheel Bearing	35	—	—	—	706179X	706179X
20	KIT – Outer Wheel Bearing	36	—	—	—	706074X	706074X
21	Spindle Nut / Wheel Bearing Retainer	38	—	—	—	39695	39695
22	Wheel Bearing Retainer (Left Hand)	-	—	—	—	—	—
23	Locking Wedge	39	—	—	—	41373	41373
24	Gear – Differential (p/l)	48	35294	35294	35294	35294	35294
25	Lockwasher	51	36526	36526	36526	36526	36526
26	Screw – Flange Head	52	39694	39694	39694	39694	39694

(See next page for additional bills of material)

# Ford Model 70 /267 Rear Axles Variable Parts Listing

Kits & Parts - Use With All Applications							
Description & Item Number (Refer to "Exploded View" at the front of this section)			Bills of Material				
			605044 605045	605053	605054	605055	605057
1	KIT – Inner Pinion Bearing	3	706060X	706060X	706060X	706060X	706060X
2	PKG – Pinion Bearing Shim	-	706357X	706357X	706357X	706357X	706357X
3	Baffle – Pinion Bearing	5	—	—	—	—	—
4	PKG – Diff & Pinion Bearing Shim	-	706213X	706213X	706213X	706213X	706213X
5	End Yoke Assembly (inc 11)	10	2-4-5311X	2-4-8051X	3-4-5731X	2-4-5311X	2-4-5311X
6	Slinger – End Yoke	11	34592	41195	34592	34592	34592
7	Companion Flange Assembly	14	—	—	—	—	—
8	KIT – Carrier Cover	-	707104X	707104X	707104X	707104X	707104X
9	Carrier Cover	15	42815-2	42815-2	42815-2	42815-2	42815-2
10	Plug – Carrier Cover	17	43180	43180	43180	43180	43180
11	Bolt – Carrier Cover (qty 10)	18	34822	34822	34822	34822	34822
12	KIT – Differential Bearing	21	706070X	706070X	706047X	706070X	706047X
13	PKG – Diff Bearing Shim (inc 16)	22	708012	708012	708012	708012	708012
14	Bolt – Drive Gear (qty 12)	24	30266	30266	30266	30266	30266
15	Gear – Differential (std)	26	35079	35079	35079	35079	35079
16	Spacer – Differential Bearing	30	—	—	—	—	—
17	Tone Ring	31	—	—	—	—	—
18	Seal – Hub	34	46004	46004	46004	46004	46004
19	KIT – Inner Wheel Bearing	35	706179X	706179X	706179X	706179X	706179X
20	KIT – Outer Wheel Bearing	36	706074X	706074X	706074X	706074X	706074X
21	Spindle Nut / Wheel Bearing Retainer	38	39695	39695	39695	39695	39695
22	Wheel Bearing Retainer (Left Hand)	-	—	—	—	—	—
23	Locking Wedge	39	41373	41373	41373	41373	41373
24	Gear – Differential (p/l)	48	35294	35294	—	35294	35294
25	Lockwasher	51	36526	36526	36526	36526	36526
26	Screw – Flange Head	52	39694	39694	39694	39694	39694
			<b>605080</b>	<b>605101</b>	<b>605114</b>	<b>605115</b>	<b>605118 605138</b>
1	KIT – Inner Pinion Bearing	3	706060X	706060X	706861X	706861X	706060X
2	PKG – Pinion Bearing Shim	-	706357X	706357X	706359X	706359X	706357X
3	Baffle – Pinion Bearing	5	—	—	—	—	—
4	PKG – Diff & Pinion Bearing Shim	-	706213X	706213X	708020	708020	706213X
5	End Yoke Assembly (inc 11)	10	2-4-5311X	2-4-5311X	2-4-8051X	2-4-5311X	2-4-5311X
6	Slinger – End Yoke	11	34592	34592	41195	34592	34592
7	Companion Flange Assembly	14	—	—	—	—	—
8	KIT – Carrier Cover	-	707104X	707105X	707104X	707104X	707104X
9	Carrier Cover	15	42815-2	42815-2	42815-2	42815-2	42815-2
10	Plug – Carrier Cover	17	43180	43181	43180	43180	43180
11	Bolt – Carrier Cover (qty 10)	18	34822	34822	34822	34822	34822
12	KIT – Differential Bearing	21	706047X	706070X	706047X	706047X	706070X
13	PKG – Diff Bearing Shim (inc 16)	22	708012	706373X	708012	708012	708012
14	Bolt – Drive Gear (qty 12)	24	30266	30266	30266	30266	30266
15	Gear – Differential (std)	26	35079	35079	35079	35079	35079
16	Spacer – Differential Bearing	30	—	34848-28	—	—	—
17	Tone Ring	31	—	—	—	—	—
18	Seal – Hub	34	46004	46004	46004	46004	46004
19	KIT – Inner Wheel Bearing	35	706179X	706179X	706179X	706179X	706179X
20	KIT – Outer Wheel Bearing	36	706074X	706074X	706074X	706074X	706074X
21	Spindle Nut / Wheel Bearing Retainer	38	39695	39695	39695	39695	39695
22	Wheel Bearing Retainer (Left Hand)	-	—	—	—	—	—
23	Locking Wedge	39	41373	41373	41373	41373	41373
24	Gear – Differential (p/l)	48	—	35294	35294	35294	35294
25	Lockwasher	51	36526	36526	36526	36526	36526
26	Screw – Flange Head	52	39694	39694	39694	39694	39694



# Ford Model 70 /267 Rear Axles

## Variable Parts Listing

Kits & Parts - Use With All Applications							
Description & Item Number (Refer to "Exploded View" at the front of this section)			Bills of Material				
			605139 605143	605170	605175	605176	605204
1	KIT – Inner Pinion Bearing	3	706060X	706060X	706861X	706060X	706861X
2	PKG – Pinion Bearing Shim	-	706357X	706357X	706359X	706357X	706359X
3	Baffle – Pinion Bearing	5	—	—	—	—	—
4	PKG – Diff & Pinion Bearing Shim	-	706213X	706213X	708020	706213X	708020
5	End Yoke Assembly (inc 11)	10	2-4-5311X	2-4-8051X	2-4-8051X	2-4-8051X	2-4-8051X
6	Slinger – End Yoke	11	34592	41195	41195	41195	41195
7	Companion Flange Assembly	14	—	—	—	—	—
8	KIT – Carrier Cover	-	707104X	707104X	707104X	707104X	707104X
9	Carrier Cover	15	42815-2	42815-2	42815-2	42815-2	42815-2
10	Plug – Carrier Cover	17	43180	43180	43180	43180	43180
11	Bolt – Carrier Cover (qty 10)	18	34822	34822	34822	34822	34822
12	KIT – Differential Bearing	21	706047X	706070X	706047X	706070X	706047X
13	PKG – Diff Bearing Shim (inc 16)	22	708012	708012	708012	708012	708012
14	Bolt – Drive Gear (qty 12)	24	30266	30266	30266	30266	30266
15	Gear – Differential (std)	26	35079	35079	35079	35079	35079
16	Spacer – Differential Bearing	30	—	—	—	—	—
17	Tone Ring	31	—	—	—	—	—
18	Seal – Hub	34	46004	46004	46004	46004	46004
19	KIT – Inner Wheel Bearing	35	706179X	706179X	706179X	706179X	706179X
20	KIT – Outer Wheel Bearing	36	706074X	706074X	706074X	706074X	706074X
21	Spindle Nut / Wheel Bearing Retainer	38	39695	39695	39695	39695	39695
22	Wheel Bearing Retainer (Left Hand)	-	—	—	—	—	—
23	Locking Wedge	39	41373	41373	41373	41373	41373
24	Gear – Differential (p/l)	48	—	35294	35294	35294	35294
25	Lockwasher	51	36526	36526	36526	36526	36526
26	Screw – Flange Head	52	39694	39694	39694	39694	39694
			<b>605206</b>	<b>605207 605205</b>	<b>605208 605213</b>	<b>605246 605247 605248</b>	<b>605249 605250</b>
1	KIT – Inner Pinion Bearing	3	706861X	706060X	706861X	706861X	706860X
2	PKG – Pinion Bearing Shim	-	706357X	706357X	706359X	706359X	706357X
3	Baffle – Pinion Bearing	5	—	41550	—	—	—
4	PKG – Diff & Pinion Bearing Shim	-	708020	706213X	708020	708020	706213X
5	End Yoke Assembly (inc 11)	10	3-4-5731X	2-4-8051X	2-4-8051X	2-4-8051X	2-4-8051X
6	Slinger – End Yoke	11	41195	41195	41195	41195	41195
7	Companion Flange Assembly	14	—	—	—	—	—
8	KIT – Carrier Cover	-	707104X	707105X	707104X	707104X	707104X
9	Carrier Cover	15	42815-2	42815-2	42815-2	42815-2	42815-2
10	Plug – Carrier Cover	17	43180	43181	43180	43180	43180
11	Bolt – Carrier Cover (qty 10)	18	34822	34822	34822	34822	34822
12	KIT – Differential Bearing	21	706047X	706070X	706047X	706047X	706070X
13	PKG – Diff Bearing Shim (inc 16)	22	708012	706373X	708012	708012	708012
14	Bolt – Drive Gear (qty 12)	24	40638	30266	30266	40638	40638
15	Gear – Differential (std)	26	35079	35079	35079	35079	35079
16	Spacer – Differential Bearing	30	—	34848-28	—	—	—
17	Tone Ring	31	—	—	—	—	—
18	Seal – Hub	34	46004	46004	46004	46004	46004
19	KIT – Inner Wheel Bearing	35	706179X	706179X	706179X	706179X	706179X
20	KIT – Outer Wheel Bearing	36	706074X	706074X	706074X	706074X	706074X
21	Spindle Nut / Wheel Bearing Retainer	38	39695	39695	39695	39695	39695
22	Wheel Bearing Retainer (Left Hand)	-	—	—	—	—	—
23	Locking Wedge	39	41373	41373	41373	41373	41373
24	Gear – Differential (p/l)	48	—	35294	35294	35294	35294
25	Lockwasher	51	36526	36526	36526	36526	36526
26	Screw – Flange Head	52	39694	39694	39694	39694	39694

(See next page for additional bills of material)

# Ford Model 70 /267 Rear Axles Variable Parts Listing

Kits & Parts - Use With All Applications							
Description & Item Number (Refer to "Exploded View" at the front of this section)			Bills of Material				
			605253	605255	605300	605337	605344
1	KIT – Inner Pinion Bearing	3	706861X	706060X	706861X	706060X	706060X
2	PKG – Pinion Bearing Shim	-	706359X	706357X	706359X	706357X	706357X
3	Baffle – Pinion Bearing	5	—	—	—	—	—
4	PKG – Diff & Pinion Bearing Shim	-	708020	706213X	708020	706213X	706213X
5	End Yoke Assembly (inc 11)	10	2-4-8051X	2-4-8051X	2-4-8051X	2-4-8051X	2-4-8051X
6	Slinger – End Yoke	11	41195	41195	41195	41195	41195
7	Companion Flange Assembly	14	—	—	—	—	—
8	KIT – Carrier Cover	-	707104X	707104X	707104X	707105X	707104X
9	Carrier Cover	15	42815-2	42815-2	42815-2	42815-2	42815-2
10	Plug – Carrier Cover	17	43180	43180	43180	43181	43180
11	Bolt – Carrier Cover (qty 10)	18	34822	34822	34822	34822	34822
12	KIT – Differential Bearing	21	706047X	706070X	706047X	706070X	706070X
13	PKG – Diff Bearing Shim (inc 16)	22	708012	708012	708012	706373X	708012
14	Bolt – Drive Gear (qty 12)	24	30266	40638	30266	30266	30266
15	Gear – Differential (std)	26	35079	35079	35079	35079	35079
16	Spacer – Differential Bearing	30	—	—	—	34848-28	—
17	Tone Ring	31	—	—	—	—	—
18	Seal – Hub	34	46004	46004	46004	46004	46004
19	KIT – Inner Wheel Bearing	35	706179X	706179X	706179X	706179X	706179X
20	KIT – Outer Wheel Bearing	36	706074X	706074X	706074X	706074X	706074X
21	Spindle Nut / Wheel Bearing Retainer	38	39695	39695	43075	43075	43075
22	Wheel Bearing Retainer (Left Hand)	-	—	—	43076	43076	43076
23	Locking Wedge	39	41373	41373	—	—	—
24	Gear – Differential (p/l)	48	35294	35294	35294	—	35294
25	Lockwasher	51	36526	36526	36526	36526	36526
26	Screw – Flange Head	52	39694	39694	39694	39694	39694
			<b>605352</b>	<b>605412</b>	<b>605421</b>	<b>605437</b>	<b>605438</b>
1	KIT – Inner Pinion Bearing	3	706861X	706861X	706861X	706861X	706060X
2	PKG – Pinion Bearing Shim	-	706359X	706359X	706359X	706359X	706357X
3	Baffle – Pinion Bearing	5	—	—	—	—	—
4	PKG – Diff & Pinion Bearing Shim	-	708020	708020	708020	708020	706213X
5	End Yoke Assembly (inc 11)	10	2-4-8051X	2-4-8051X	2-4-8051X	2-4-8051X	2-4-8051X
6	Slinger – End Yoke	11	41195	41195	41195	41195	41195
7	Companion Flange Assembly	14	—	—	—	—	—
8	KIT – Carrier Cover	-	707104X	707104X	707105X	707104X	707104X
9	Carrier Cover	15	42815-2	42815-2	42815-2	42815-2	42815-2
10	Plug – Carrier Cover	17	43180	43180	43181	43180	43180
11	Bolt – Carrier Cover (qty 10)	18	34822	34822	34822	34822	34822
12	KIT – Differential Bearing	21	706047X	706047X	706047X	706047X	706070X
13	PKG – Diff Bearing Shim (inc 16)	22	708012	708012	708012	708012	706373X
14	Bolt – Drive Gear (qty 12)	24	30266	30266	30266	30266	30266
15	Gear – Differential (std)	26	35079	35079	35079	35079	35079
16	Spacer – Differential Bearing	30	—	42563	42563	42563	34848-28
17	Tone Ring	31	—	—	42929	—	—
18	Seal – Hub	34	46004	46004	46004	46004	46004
19	KIT – Inner Wheel Bearing	35	706179X	706179X	706179X	706179X	706179X
20	KIT – Outer Wheel Bearing	36	706074X	706074X	706074X	706074X	706074X
21	Spindle Nut / Wheel Bearing Retainer	38	43075	43075	43075	43075	43075
22	Wheel Bearing Retainer (Left Hand)	-	43076	43076	—	43076	43076
23	Locking Wedge	39	—	—	—	—	—
24	Gear – Differential (p/l)	48	—	35294	35294	—	35294
25	Lockwasher	51	36526	36526	36526	36526	36526
26	Screw – Flange Head	52	39694	39694	39694	39694	39694

## Ford Model 70 /267 Rear Axles Variable Parts Listing

Kits & Parts - Use With All Applications							
Description & Item Number (Refer to "Exploded View" at the front of this section)			Bills of Material				
			605471	605480	605488	605501 605518 605537	605538
1	KIT – Inner Pinion Bearing	3	706060X	706060X	706861X	706861X	706060X
2	PKG – Pinion Bearing Shim	-	706357X	706357X	706359X	706359X	706357X
3	Baffle – Pinion Bearing	5	—	—	—	—	—
4	PKG – Diff & Pinion Bearing Shim	-	706213X	706213X	708020	708020	706213X
5	End Yoke Assembly (inc 11)	10	2-4-8051X	2-4-8051X	2-4-8051X	2-4-8051X	2-4-8051X
6	Slinger – End Yoke	11	41195	41195	41195	41195	41195
7	Companion Flange Assembly	14	—	—	—	—	—
8	KIT – Carrier Cover	-	707105X	707104X	707105X	707105X	707105X
9	Carrier Cover	15	42815-2	42815-2	42815-2	42815-2	42815-2
10	Plug – Carrier Cover	17	43181	43180	43181	43181	43181
11	Bolt – Carrier Cover (qty 10)	18	34822	34822	34822	34822	34822
12	KIT – Differential Bearing	21	706070X	706070X	706047X	706047X	706070X
13	PKG – Diff Bearing Shim (inc 16)	22	706373X	706373X	708012	708012	706373X
14	Bolt – Drive Gear (qty 12)	24	30266	30266	30266	30266	30266
15	Gear – Differential (std)	26	35079	35079	35079	35079	35079
16	Spacer – Differential Bearing	30	34848-28	34848-28	42563	42563	34848-28
17	Tone Ring	31	42929	42929	42929	42929	42929
18	Seal – Hub	34	46004	46004	46004	46004	46004
19	KIT – Inner Wheel Bearing	35	706179X	706179X	706179X	706179X	706179X
20	KIT – Outer Wheel Bearing	36	706074X	706074X	706074X	706074X	706074X
21	Spindle Nut / Wheel Bearing Retainer	38	—	—	—	—	43075
22	Wheel Bearing Retainer (Left Hand)	-	—	—	—	—	—
23	Locking Wedge	39	43075	43075	43075	43075	—
24	Gear – Differential (p/l)	48	35294	—	35294	—	35294
25	Lockwasher	51	36526	36526	36526	36526	36526
26	Screw – Flange Head	52	39694	39694	39694	39694	39694
			<b>605539</b>	<b>605540</b>	<b>605567</b>	<b>605578</b>	<b>605583 605584</b>
1	KIT – Inner Pinion Bearing	3	706060X	706861X	706861X	706861X	706861X
2	PKG – Pinion Bearing Shim	-	706357X	706359X	706359X	706359X	706359X
3	Baffle – Pinion Bearing	5	—	—	—	—	—
4	PKG – Diff & Pinion Bearing Shim	-	706213X	708020	708020	708020	708020
5	End Yoke Assembly (inc 11)	10	2-4-8051X	2-4-8051X	2-4-8051X	2-4-8051X	2-4-8051X
6	Slinger – End Yoke	11	41195	41195	41195	41195	41195
7	Companion Flange Assembly	14	—	—	—	—	—
8	KIT – Carrier Cover	-	707105X	707105X	707105X	707105X	707105X
9	Carrier Cover	15	42815-2	42815-2	42815-2	42815-2	42815-2
10	Plug – Carrier Cover	17	43181	43181	43181	43181	43181
11	Bolt – Carrier Cover (qty 10)	18	34822	34822	34822	34822	34822
12	KIT – Differential Bearing	21	706070X	706047X	706047X	706047X	706047X
13	PKG – Diff Bearing Shim (inc 16)	22	706373X	708012	708012	708012	708012
14	Bolt – Drive Gear (qty 12)	24	30266	30266	30266	30266	30266
15	Gear – Differential (std)	26	35079	35079	43913	43913	43913
16	Spacer – Differential Bearing	30	34848-28	42563	42563	42563	42563
17	Tone Ring	31	42929	42929	42929	42929	42929
18	Seal – Hub	34	46004	46004	46004	46004	46004
19	KIT – Inner Wheel Bearing	35	706179X	706179X	706179X	706179X	706179X
20	KIT – Outer Wheel Bearing	36	706074X	706074X	706074X	706074X	706074X
21	Spindle Nut / Wheel Bearing Retainer	38	43075	43075	43075	43075	43075
22	Wheel Bearing Retainer (Left Hand)	-	—	—	—	—	—
23	Locking Wedge	39	—	—	—	—	—
24	Gear – Differential (p/l)	48	—	—	43914	43914	—
25	Lockwasher	51	—	36526	36526	—	—
26	Screw – Flange Head	52	45720	39694	39694	45720	45720

(See next page for additional bills of material)

# Ford Model 70 /267 Rear Axles

## Variable Parts Listing

Kits & Parts - Use With All Applications							
Description & Item Number (Refer to "Exploded View" at the front of this section)			Bills of Material				
			605608	605609	605640	605665	605666
1	KIT – Inner Pinion Bearing	3	706861X	706060X	706861X	706060X	706060X
2	PKG – Pinion Bearing Shim	-	706359X	706357X	706359X	706357X	706357X
3	Baffle – Pinion Bearing	5	—	—	—	—	—
4	PKG – Diff & Pinion Bearing Shim	-	708020	706213X	708020	706213X	706213X
5	End Yoke Assembly (inc 11)	10	3-4-13031-1X	3-4-13031-1X	2-4-8051X	3-4-13031-1X	2-4-8051X
6	Slinger – End Yoke	11	45799	45799	41195	45799	41195
7	Companion Flange Assembly	14	—	—	—	—	—
8	KIT – Carrier Cover	-	707105X	707105X	707105X	707105X	707105X
9	Carrier Cover	15	42815-2	42815-2	42815-2	42815-2	42815-2
10	Plug – Carrier Cover	17	43181	43181	43181	43181	43181
11	Bolt – Carrier Cover (qty 10)	18	34822	34822	34822	34822	34822
12	KIT – Differential Bearing	21	706047X	706070X	706047X	706070X	706070X
13	PKG – Diff Bearing Shim (inc 16)	22	708012	706373X	708012	706373X	706373X
14	Bolt – Drive Gear (qty 12)	24	30266	30266	30266	30266	30266
15	Gear – Differential (std)	26	43913	35079	43913	35079	35079
16	Spacer – Differential Bearing	30	42563	34848-28	42563	34848-28	34848-28
17	Tone Ring	31	42929	42929	42929	42929	42929
18	Seal – Hub	34	46004	46004	46004	46004	46004
19	KIT – Inner Wheel Bearing	35	706179X	706179X	706179X	706179X	706179X
20	KIT – Outer Wheel Bearing	36	706074X	706074X	706074X	706074X	706074X
21	Spindle Nut / Wheel Bearing Retainer	38	43075	43075	43075	43075	43075
22	Wheel Bearing Retainer (Left Hand)	-	—	—	—	—	—
23	Locking Wedge	39	—	—	—	—	—
24	Gear – Differential (p/l)	48	43914	43914	—	—	—
25	Lockwasher	51	—	—	—	—	—
26	Screw – Flange Head	52	45720	45720	45720	45720	45720
			<b>605667</b>	<b>605669</b>	<b>605671</b>	<b>605672</b>	<b>605673</b>
1	KIT – Inner Pinion Bearing	3	706060X	706861X	706861X	706060X	706861X
2	PKG – Pinion Bearing Shim	-	706357X	706359X	706359X	706357X	706359X
3	Baffle – Pinion Bearing	5	—	—	—	—	—
4	PKG – Diff & Pinion Bearing Shim	-	706213X	708020	708020	706213X	708020
5	End Yoke Assembly (inc 11)	10	3-4-13031-2X	3-4-13031-1X	3-4-13031-2X	3-4-13031-2X	2-4-8051X
6	Slinger – End Yoke	11	45799	45799	45799	45799	41195
7	Companion Flange Assembly	14	—	—	—	—	—
8	KIT – Carrier Cover	-	707105X	707105X	707105X	707105X	707105X
9	Carrier Cover	15	42815-2	42815-2	42815-2	42815-2	42815-2
10	Plug – Carrier Cover	17	43181	43181	43181	43181	43181
11	Bolt – Carrier Cover (qty 10)	18	34822	34822	34822	34822	34822
12	KIT – Differential Bearing	21	706070X	706047X	706047X	706070X	706047X
13	PKG – Diff Bearing Shim (inc 16)	22	706373X	708012	708012	706373X	708012
14	Bolt – Drive Gear (qty 12)	24	30266	30266	30266	30266	30266
15	Gear – Differential (std)	26	35079	43913	43913	35079	43913
16	Spacer – Differential Bearing	30	34848-28	42563	42563	34848-28	42563
17	Tone Ring	31	42929	42929	42929	42929	42929
18	Seal – Hub	34	46004	46004	46004	46004	46004
9	KIT – Inner Wheel Bearing Kit	35	706179X	706179X	706179X	706179X	706179X
20	KIT – Outer Wheel Bearing	36	706074X	706074X	706074X	706074X	706074X
21	Spindle Nut / Wheel Bearing Retainer	38	43075	43075	43075	43075	43075
22	Wheel Bearing Retainer (Left Hand)	-	—	—	—	—	—
23	Locking Wedge	39	—	—	—	—	—
24	Gear – Differential (p/l)	48	—	—	43914	35294	43914
25	Lockwasher	51	—	—	—	—	—
26	Screw – Flange Head	52	45720	45720	45720	45720	45720

## Ford Model 70 /267 Rear Axles Variable Parts Listing

Kits & Parts - Use With All Applications							
Description & Item Number (Refer to "Exploded View" at the front of this section)			Bills of Material				
			605675	605686	605687	605688	605689
1	KIT – Inner Pinion Bearing	3	706060X	706861X	706861X	706060X	706861X
2	PKG – Pinion Bearing Shim	-	706357X	706359X	706359X	706357X	706359X
3	Baffle – Pinion Bearing	5	—	—	—	—	—
4	PKG – Diff & Pinion Bearing Shim	-	706213X	708020	708020	706213X	708020
5	End Yoke Assembly (inc 11)	10	2-4-8051X	3-4-13031-2X	2-4-8051X	2-4-8051X	3-4-13031-2X
6	Slinger – End Yoke	11	41195	45799	41195	41195	45799
7	Companion Flange Assembly	14	—	—	—	—	—
8	KIT – Carrier Cover	-	707105X	707105X	707105X	707105X	707105X
9	Carrier Cover	15	42815-2	42815-2	42815-2	42815-2	42815-2
10	Plug – Carrier Cover	17	43181	43181	43181	43181	43181
11	Bolt – Carrier Cover (qty 10)	18	34822	34822	34822	34822	34822
12	KIT – Differential Bearing	21	706070X	706047X	706047X	706070X	706047X
13	PKG – Diff Bearing Shim (inc 16)	22	706373X	708012	708012	706373X	708012
14	Bolt – Drive Gear (qty 12)	24	30266	40638	40638	40638	40638
15	Gear – Differential (std)	26	35079	43913	43913	35079	43913
16	Spacer – Differential Bearing	30	34848-28	42563	42563	34848-28	42563
17	Tone Ring	31	42929	42929	42929	42929	42929
18	Seal – Hub	34	46004	46004	46004	46004	46004
19	KIT – Inner Wheel Bearing	35	706179X	706179X	706179X	706179X	706179X
20	KIT – Outer Wheel Bearing	36	706074X	706074X	706074X	706074X	706074X
21	Spindle Nut / Wheel Bearing Retainer	38	43075	43075	43075	43075	43075
22	Wheel Bearing Retainer (Left Hand)	-	—	—	—	—	—
23	Locking Wedge	39	—	—	—	—	—
24	Gear – Differential (p/l)	48	35294	43914	43914	35294	43914
25	Lockwasher	51	—	—	—	—	—
26	Screw – Flange Head	52	45720	45720	45720	45720	45720
			<b>605690</b>	<b>605692</b>	<b>605693</b>	<b>605714</b>	<b>605715</b>
1	KIT – Inner Pinion Bearing	3	706060X	706060X	706060X	706861X	706060X
2	PKG – Pinion Bearing Shim	-	706357X	706357X	706357X	706359X	706357X
3	Baffle – Pinion Bearing	5	—	—	—	—	—
4	PKG – Diff & Pinion Bearing Shim	-	706213X	706213X	706213X	708020	706213X
5	End Yoke Assembly (inc 11)	10	3-4-13031-2X	3-4-13031-2X	2-4-8051X	3-4-13031-2X	3-4-13031-2X
6	Slinger – End Yoke	11	45799	45799	41195	45799	45799
7	Companion Flange Assembly	14	—	—	—	—	—
8	KIT – Carrier Cover	-	707105X	707105X	707105X	707105X	707105X
9	Carrier Cover	15	42815-2	42815-2	42815-2	42815-2	42815-2
10	Plug – Carrier Cover	17	43181	43181	43181	43181	43181
11	Bolt – Carrier Cover (qty 10)	18	34822	34822	34822	34822	34822
12	KIT – Differential Bearing	21	706070X	706070X	706070X	706047X	706070X
13	PKG – Diff Bearing Shim (inc 16)	22	706373X	706373X	706373X	708012	706373X
14	Bolt – Drive Gear (qty 12)	24	40638	30266	30266	30266	30266
15	Gear – Differential (std)	26	35079	35079	35079	43913	35079
16	Spacer – Differential Bearing	30	34848-28	34848-28	34848-28	42563	34848-28
17	Tone Ring	31	42929	42929	42929	42929	42929
18	Seal – Hub	34	46004	46004	46004	46004	46004
19	KIT – Inner Wheel Bearing	35	706179X	706179X	706179X	706179X	706179X
20	KIT – Outer Wheel Bearing	36	706074X	706074X	706074X	706074X	706074X
21	Spindle Nut / Wheel Bearing Retainer	38	43075	43075	43075	43075	43075
22	Wheel Bearing Retainer (Left Hand)	-	—	—	—	—	—
23	Locking Wedge	39	—	—	—	—	—
24	Gear – Differential (p/l)	48	35294	—	—	43914	35294
25	Lockwasher	51	—	—	—	—	—
26	Screw – Flange Head	52	45720	45720	45720	45720	45720

(See next page for additional bills of material)



# Ford Model 70 /267 Rear Axles Variable Parts Listing

Kits & Parts - Use With All Applications							
Description & Item Number (Refer to "Exploded View" at the front of this section)			Bills of Material				
			605844	605845	605846	605847	605848
1	KIT – Inner Pinion Bearing	3	706861X	706861X	706060X	706861X	706060X
2	PKG – Pinion Bearing Shim	-	706359X	706359X	706357X	706359X	706357X
3	Baffle – Pinion Bearing	5	—	—	—	—	—
4	PKG – Diff & Pinion Bearing Shim	-	708020	708020	706213X	708020	706213X
5	End Yoke Assembly (inc 11)	10	3-4-13031-2X	2-4-8051X	2-4-8051X	3-4-13031-2X	3-4-13031-2X
6	Slinger – End Yoke	11	45799	41195	41195	45799	45799
7	Companion Flange Assembly	14	—	—	—	—	—
8	KIT – Carrier Cover	-	707105X	707105X	707105X	707105X	707105X
9	Carrier Cover	15	42815-2	42815-2	42815-2	42815-2	42815-2
10	Plug – Carrier Cover	17	43181	43181	43181	43181	43181
11	Bolt – Carrier Cover (qty 10)	18	34822	34822	34822	34822	34822
12	KIT – Differential Bearing	21	706047X	706047X	706070X	706047X	706070X
13	PKG – Diff Bearing Shim (inc 16)	22	708012	708012	706373X	708012	706373X
14	Bolt – Drive Gear (qty 12)	24	40638	40638	40638	40638	40638
15	Gear – Differential (std)	26	43913	43913	35079	43913	35079
16	Spacer – Differential Bearing	30	42563	42563	34848-28	42563	34848-28
17	Tone Ring	31	42929	42929	42929	42929	42929
18	Seal – Hub	34	46004	46004	46004	46004	46004
19	KIT – Inner Wheel Bearing	35	706179X	706179X	706179X	706179X	706179X
20	KIT – Outer Wheel Bearing	36	706074X	706074X	706074X	706074X	706074X
21	Spindle Nut / Wheel Bearing Retainer	38	43075	43075	43075	43075	43075
22	Wheel Bearing Retainer (Left Hand)	-	—	—	—	—	—
23	Locking Wedge	39	—	—	—	—	—
24	Gear – Differential (p/l)	48	43914	43914	35294	43914	35294
25	Lockwasher	51	—	—	—	—	—
26	Screw – Flange Head	52	45720	45720	45720	45720	45720
			<b>605860</b>	<b>605861</b>	<b>605862</b>	<b>605929</b>	<b>605950 605951</b>
1	KIT – Inner Pinion Bearing	3	706861X	706861X	706060X	706060X	706861X
2	PKG – Pinion Bearing Shim	-	706359X	706359X	706357X	706357X	708709
3	Baffle – Pinion Bearing	5	—	—	—	—	—
4	PKG – Diff & Pinion Bearing Shim	-	708020	708020	706213X	706213X	708078
5	End Yoke Assembly (inc 11)	10	3-4-13031-2X	2-4-8051X	3-4-13031-2X	3-4-13031-2X	—
6	Slinger – End Yoke	11	45799	41195	45799	45799	45799
7	Companion Flange Assembly	14	—	—	—	—	3-1-4881X
8	KIT – Carrier Cover	-	707105X	707105X	707105X	707105X	707105-1X
9	Carrier Cover	15	42815-2	42815-2	42815-2	42815-2	42815-2
10	Plug – Carrier Cover	17	43181	43181	43181	43181	43181
11	Bolt – Carrier Cover (qty 10)	18	34822	34822	34822	34822	47508-1
12	KIT – Differential Bearing	21	706047X	706047X	706070X	706070X	706047X
13	PKG – Diff Bearing Shim (inc 16)	22	708012	708012	706373X	708012	701144X
14	Bolt – Drive Gear (qty 12)	24	40638	40638	40638	40638	40638
15	Gear – Differential (std)	26	43913	43913	35079	35079	43913
16	Spacer – Differential Bearing	30	42563	42563	34848-28	34848-28	47560 <sup>(9)</sup>
17	Tone Ring	31	42929	42929	42929	42929	42929
18	Seal – Hub	34	46004	46004	46004	46004	47507
19	KIT – Inner Wheel Bearing	35	706179X	706179X	706179X	706179X	706179X
20	KIT – Outer Wheel Bearing	36	706074X	706074X	706074X	706074X	706074X
21	Spindle Nut / Wheel Bearing Retainer	38	43075	43075	43075	43075	43075
22	Wheel Bearing Retainer (Left Hand)	-	—	—	—	—	—
23	Locking Wedge	39	—	—	—	—	—
24	Gear – Differential (p/l)	48	—	—	—	—	43914
25	Lockwasher	51	—	—	—	—	—
26	Screw – Flange Head	52	45720	45720	45720	45720	45720

## Ford Model 70 /267 Rear Axles Variable Parts Listing

Kits & Parts - Use With All Applications							
Description & Item Number (Refer to "Exploded View" at the front of this section)			Bills of Material				
			606020 606021	606028	606158 606159	606160	
1	KIT – Inner Pinion Bearing	3	706861X	706060X	706861X	706060X	
2	PKG – Pinion Bearing Shim	-	708709	708709	708709	708709	
3	Baffle – Pinion Bearing	5	—	—	—	—	
4	PKG – Diff & Pinion Bearing Shim	-	708078	708078	708078	707485X	
5	End Yoke Assembly (inc 11)	10	—	—	—	—	
6	Slinger – End Yoke	11	45799	45799	45799	45799	
7	Companion Flange Assembly	14	3-1-4881X	3-1-4881X	3-1-4881X	3-1-4881X	
8	KIT – Carrier Cover	-	707105-1X	707105-1X	707105-1X	707105-1X	
9	Carrier Cover	15	42815-2	42815-2	42815-2	42815-2	
10	Plug – Carrier Cover	17	43181	43181	43181	43181	
11	Bolt – Carrier Cover (qty 10)	18	47508-1	47508-1	47508-1	47508-1	
12	KIT – Differential Bearing	21	707489X	706070X	707489X	706070X	
13	PKG – Diff Bearing Shim (inc 16)	22	701144X	701144X	701144X	701144X	
14	Bolt – Drive Gear (qty 12)	24	40638	40638	40638	40638	
15	Gear – Differential (std)	26	43913	35079	43913	35079	
16	Spacer – Differential Bearing	30	47560 <sup>(9)</sup>	47560 <sup>(9)</sup>	47560 <sup>(9)</sup>	48849 <sup>(9)</sup>	
17	Tone Ring	31	42929	42929	42929	42929	
18	Seal – Hub	34	47507	47507	47507	47507	
19	KIT – Inner Wheel Bearing	35	706179X	706179X	706179X	706179X	
20	KIT – Outer Wheel Bearing	36	706074X	706074X	706074X	706074X	
21	Spindle Nut / Wheel Bearing Retainer	38	43075	43075	43075	43075	
22	Wheel Bearing Retainer (Left Hand)	-	—	43075	43075	43075	
23	Locking Wedge	39	—	—	—	—	
24	Gear – Differential (p/l)	48	43914	—	43914	—	
25	Lockwasher	51	—	—	—	—	
26	Screw – Flange Head	52	45720	45720	45720	45720	

(9) For selection thickness on 47560 and 48849 shims, see Differential Bearing Adjustment Shim Table at the end of the Ford section of this catalog.